

Double-Pole and Single-Pole Rocker Power Switches

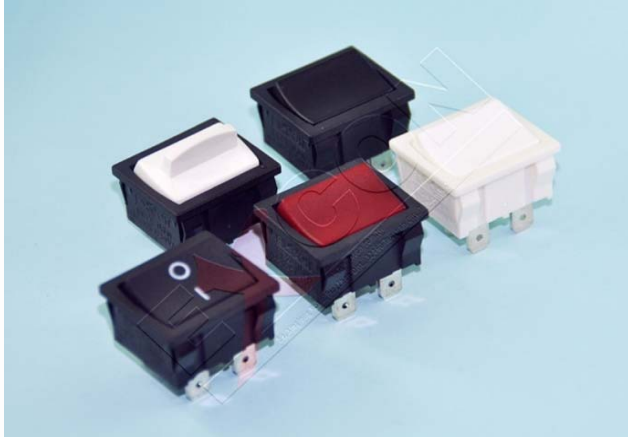

Approval & Rating:

Rating	Approval
16(4)A 250VAC~T125/55	
6A 125/250VAC~T125/85 10A 125/250VAC~T125/85 12A 125/250VAC~T125/85 16(4)A 250VAC~T125/85	

PANEL CUTOUT DIMENSION:
(面板安裝孔開口尺寸)

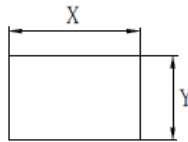

PANEL THICKNESS	X	Y
0.75~1.25mm	19.2 $\begin{smallmatrix} +0.0 \\ -0.1 \end{smallmatrix}$ mm	12.9 $\begin{smallmatrix} +0.1 \\ -0.0 \end{smallmatrix}$ mm
1.25~2.0mm	19.4 $\begin{smallmatrix} +0.0 \\ -0.1 \end{smallmatrix}$ mm	12.9 $\begin{smallmatrix} +0.1 \\ -0.0 \end{smallmatrix}$ mm
2.0~3.0mm	19.8 $\begin{smallmatrix} +0.0 \\ -0.1 \end{smallmatrix}$ mm	12.9 $\begin{smallmatrix} +0.1 \\ -0.0 \end{smallmatrix}$ mm

Electrical(電氣性能):

(接觸電阻) INITIAL CONTACT RESISTANCE: 20Ω Max

(操作力量) OPERATION FORCE: 500±300gf

(絕緣電阻) INSULATION RESISTANCE: 100mΩ Min 500VDC

(電氣壽命) ENDURANCE: 10,000 CYCLES

SPEC DRAWING(規格圖面)

Unit: mm

SS24-WBNNC-P20-R

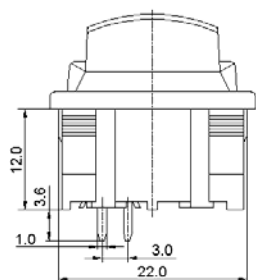
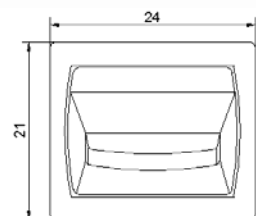
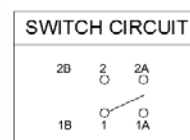

SS24-BBIWQ-R40-R

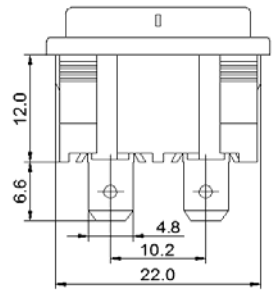
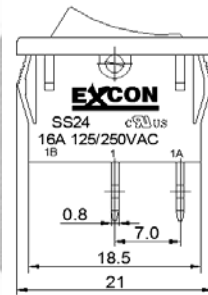
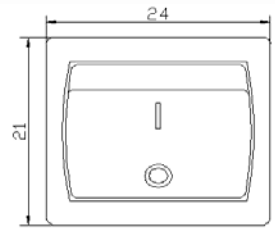
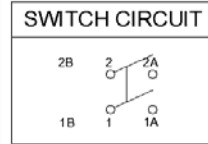
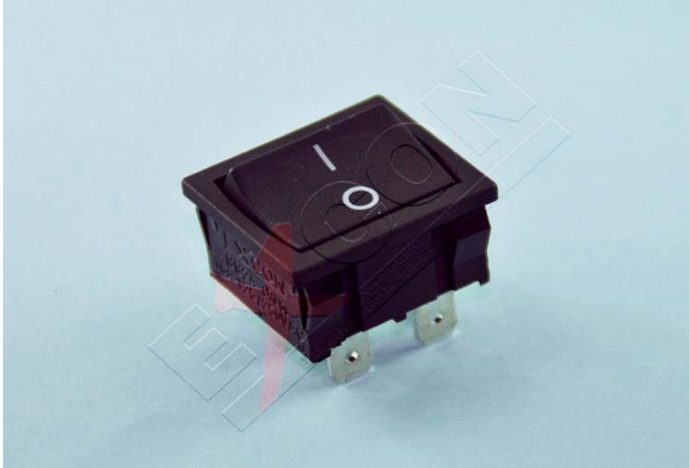

SS24-BBIWG-R40-R

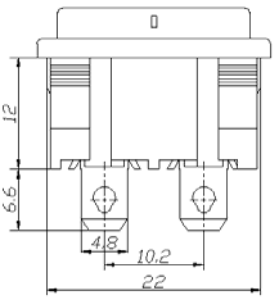
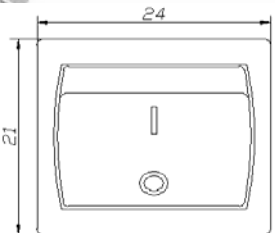
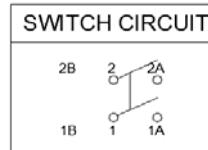

89, Xing Long Road, Ping...

HOW TO ORDER(採購識別碼)

SS24 SERIES ORDERING SYSTEM

MODEL NO. **SS24 - B B I W Q - R A 4 0 - R**

ACTUATOR COLOR		HOUSING COLOR		PRINTING COLOR		ACTUATOR TYPE		RATING		RoHS DIRECTIVE	
B	BLACK	W	WHITE	W	WHITE	R	ROCKER		12A 125/250VAC	R	MEET RoHS DIRECTIVE
R	RED	E	GREY	B	BLACK	P	PADDLE	A	12A 125/250VAC		NONE
				N	NONE						

PRINTING OPTION					TERMINAL TYPE		CURRENT CIRCUIT				
I		D		V		Q	QUICK-CONN				
N		O		Q		S	SOLDERING	21 (ON)	-	OFF	SPST
T		E				C	CUSTOMER DESIGN	22 ON	-	(OFF)	
C		W				G	QUICK-CONN	30 ON	-	ON	SPDT
						B	PCB TYPE (VERTICAL 6.6mm)	31 (ON)	-	ON	SPDT
								40 ON	-	OFF	
								41 (ON)	-	OFF	DPST
								42 ON	-	(OFF)	
								60 ON	-	ON	DPDT
								61 (ON)	-	ON	DPDT

