

PART NO.  
660500TD051  
DWG NO.  
C6605TD

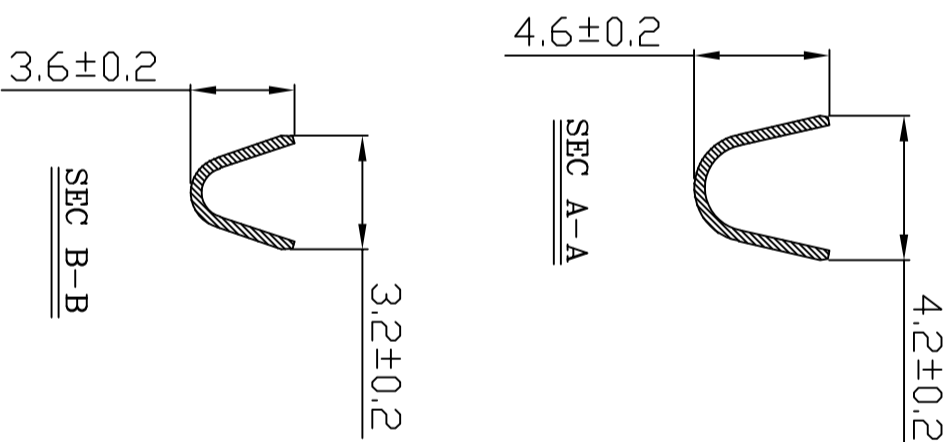

- NOTE:
1. Terminal Material: See table
  2. Plated: Ni 25u"min Tin-plated 50u"min.
  3. Insulation O.D.: 1.0~2.1
  4. Applicable wires: #24~#18
  5. Q'ty / reel: 7,000pcs

No.	Part No.	Material	Finish
1	660500TE051	Brass	Tin pre-plated
2	660500TD051		
3	660500TE351	phosphor	
4	660500TD351		

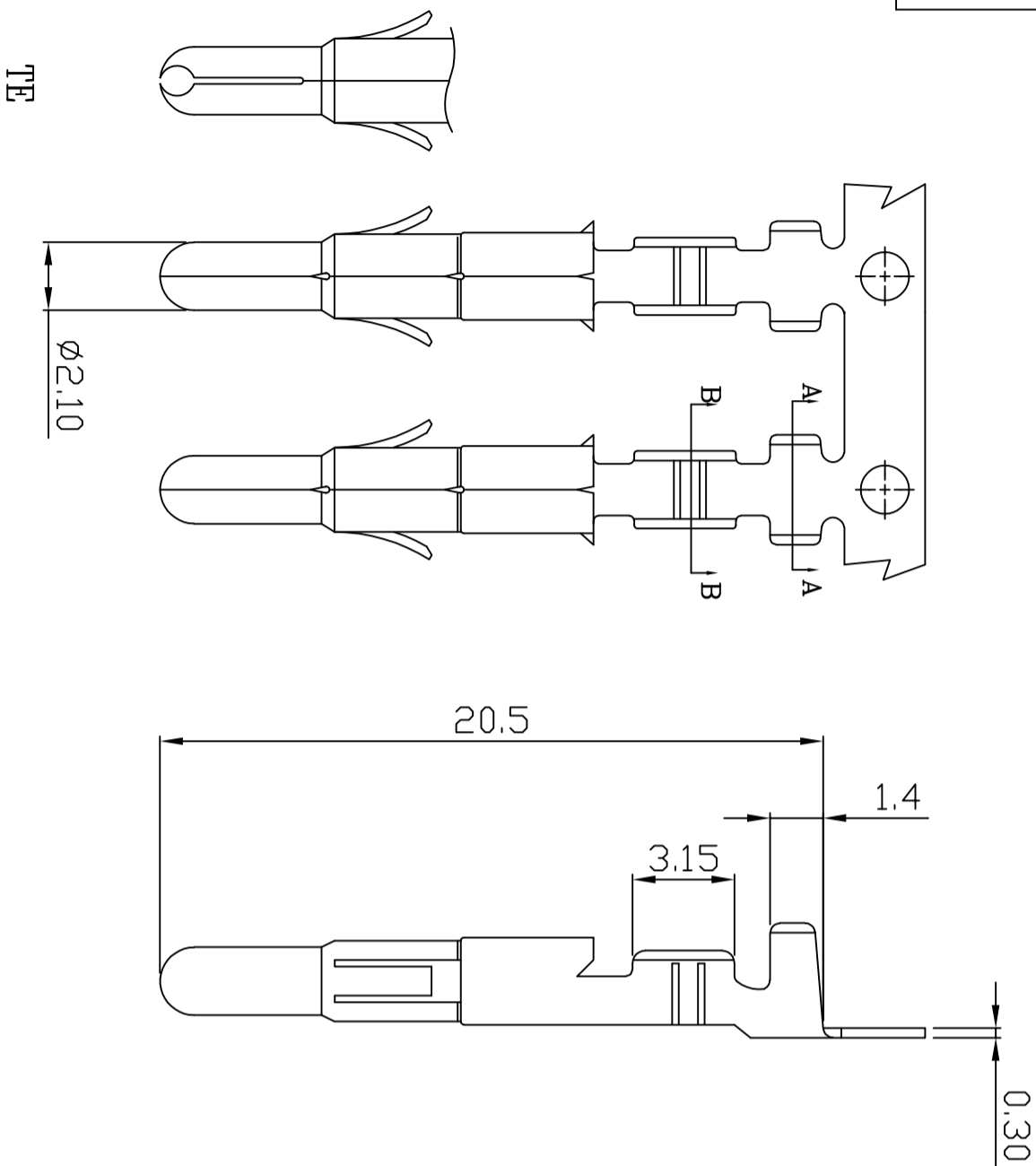
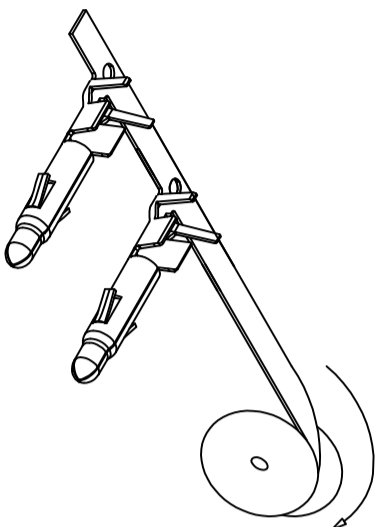
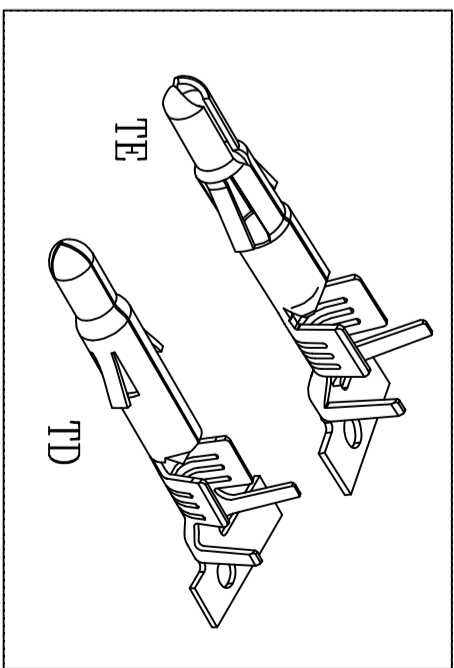

REV.	REVISION	UNIT	DIS	DATE	UNLESS OTHERWISE SPECIFIED TOLERANCES
					3 PLACE ±0.5 ±0.10
					2 PLACE ±1.5 ±0.25
					1 PLACE ±2.0 ±0.50

SCALE	REV.	PAGE	UNIT	DWG NO.	PART NO
NONE	B	1	TYRD ANGLE PROJECTION	C6605TD	660500TD051

**EXCON**

EXCON TECHNOLOGY COMPANY