

PART NO.  
660500TA051  
DWG NO.  
C6605TA

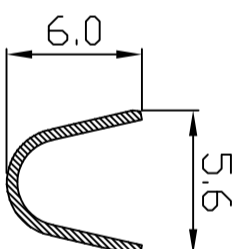

SEC A-A

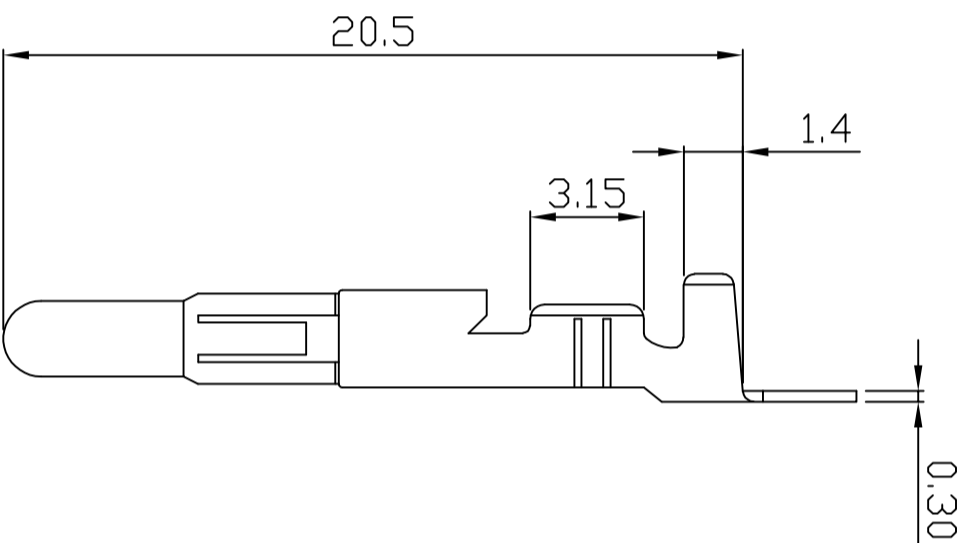
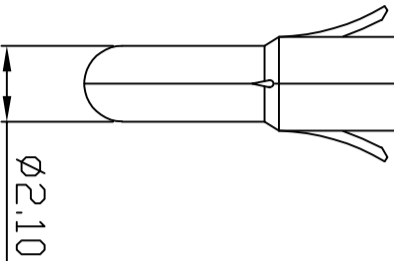
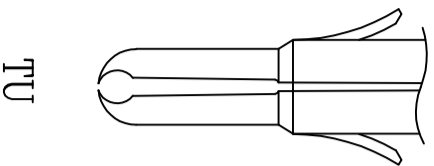
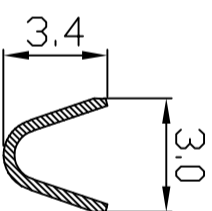

SEC B-B

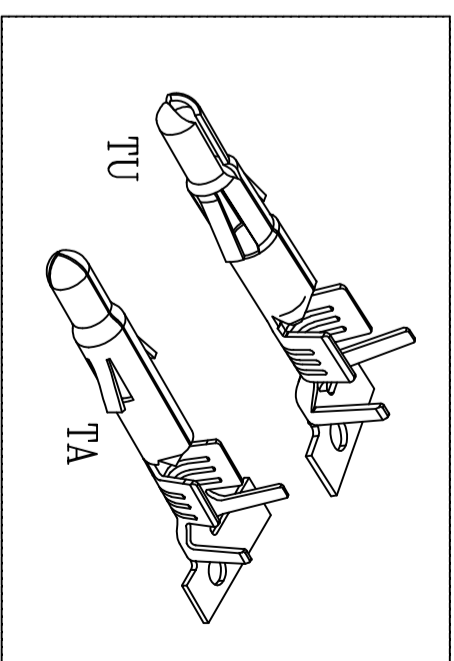

- NOTE:
1. Terminal Material: See table
  2. Plated: Ni 25u"min Tin-plated 50u"min.
  3. Insulation O.D.: 1.7~3.0
  4. Applicable wires: #18~#14
  5. Q'ty / reel: 3,000pcs

No.	Part No.	Material	Finish
1	660500TA051	Brass	Tin pre-plated
2	660500TU051		
3	660500TA351	phosphor	
4	660500TU351		

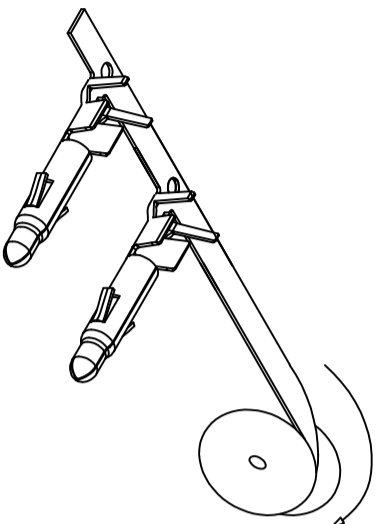

REV.	REV.	PAGE:	REVISION:	UNIT	DIS	DATE	UNLESS OTHERWISE SPECIFIED TOLERANCES	DWG NO.:	PART.NO
							3 PLACE ±0.5 ±0.10	C6605TA	660500TA051
							2 PLACE ±1.5 ±0.25		
							1 PLACE ±2.0 ±0.50		
SCALE	REV.	PAGE:	REVISION:	UNIT	DIS	DATE	ANGLE DIM		
NONE	B	1		TYRD ANGLE PROJECTION					

**EXCON**

EXCON TECHNOLOGY COMPANY