

PART NO. 8202xxSM001
 DWG NO. C8202SM

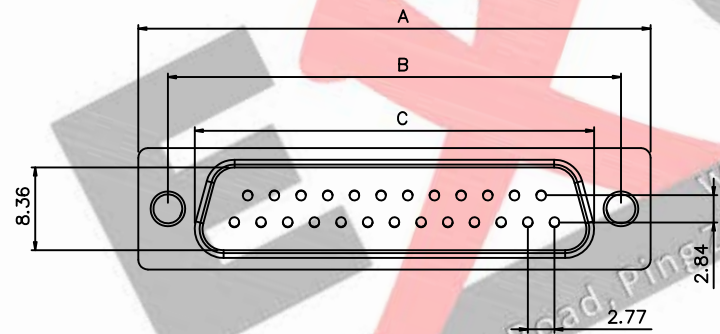
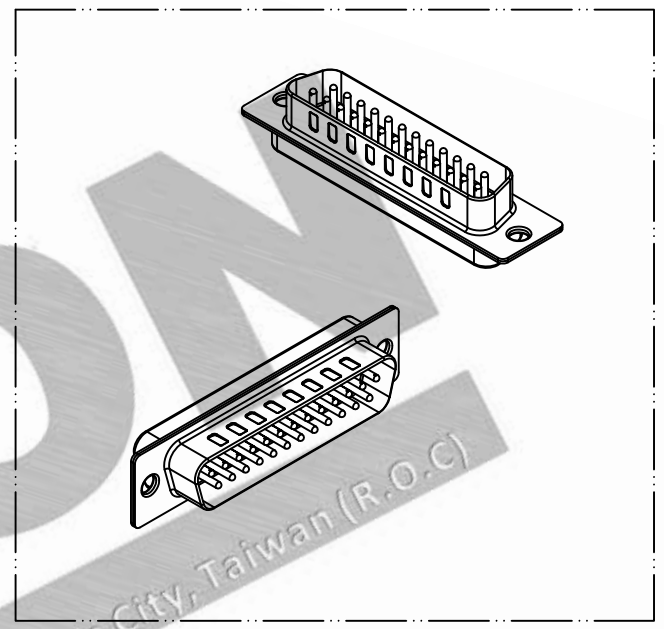
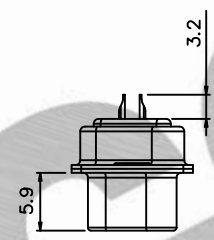
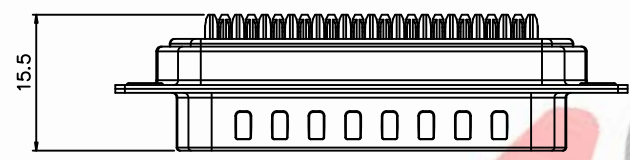
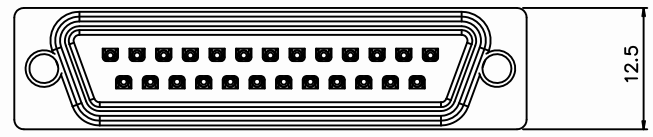

Dimensional & Ordering Information:

Part No.	POS	A	B	C
820209SM002	09	30.81	24.99	16.92
820215SM002	15	39.14	33.32	25.25
820225SM002	25	53.04	47.04	38.96
820237SM002	37	69.32	63.50	55.42

NOTE:

1. Wafer Material: PBT UL94V-0
Pin/Pos Material: brass bronze.
2. Plated: Tin-plated 50u"min.
3. Insulation resistance: 1000M ohm/min.
4. Withstand voltage: 1000V AC/minute.
5. Current retang: 3A AC/DC.
6. Voltage rating: 250V AC/DC

				UNLESS OTHERWISE SPECIFIED TOLERANCES		EXCON EXCON TECHNOLOGY COMPANY
				3 PLACE ±0.5 ±0.10		
				2 PLACE ±1.5 ±0.35		
				1 PLACE ±2.0 ±0.50		
				ANGLE DIM		
REV.	REVISIONI			DIS	DATE	
SCALE	REV.	PAGE:	UNIT	mm		DWG NO:
1/1	A	2	THIRD ANGLE PROJECTION			C8202SM
					PART.NO	
					8202xxSM001	