

PART NO. 7805xxLB051
 DWG NO. C7805LB

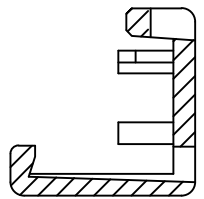

SEC B-B

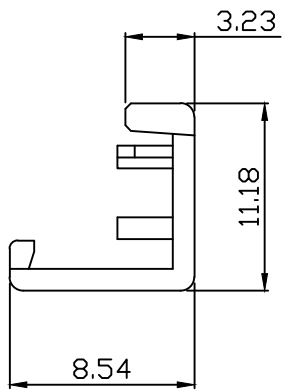
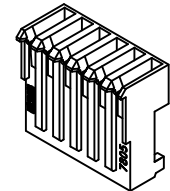
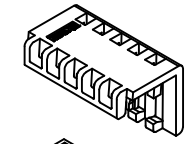
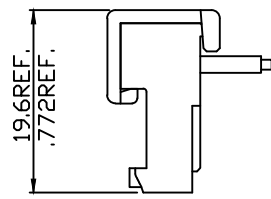
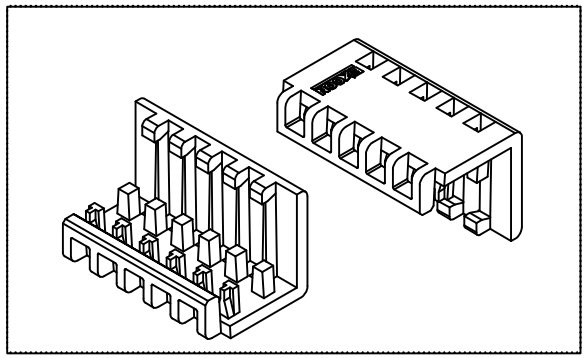
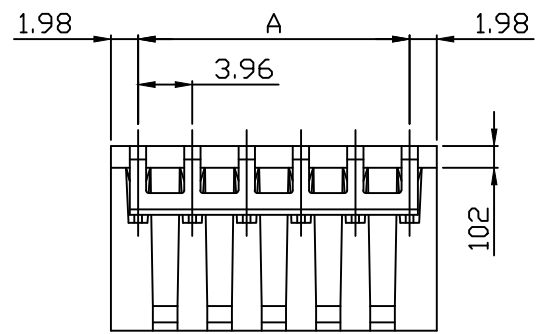
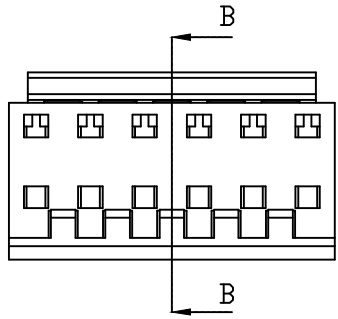

Dimensional & Ordering Information:

Part No.	Circuits	Dim A
780502LB051	2	3.96
780503LB051	3	7.92
780504LB051	4	11.88
780505LB051	5	15.84
780506LB051	6	19.80
780507LB051	7	23.76
780508LB051	8	27.72
780509LB051	9	31.68
780510LB051	10	35.64
780511LB051	11	39.60
780512LB051	12	43.56
780513LB051	13	47.52
780514LB051	14	51.48
780515LB051	15	55.44
780516LB051	16	59.40
780517LB051	17	63.36
780518LB051	18	67.32
780519LB051	19	71.28
780520LB051	20	75.24
780521LB051	21	79.20
780522LB051	22	83.16
780523LB051	23	87.12
780524LB051	24	91.08

NOTE:

- Housing Material: Nylon 66 UL94V2
- Color: Natural
- Withstand voltage: 1500V AC/minute.
- Current rating: 5A AC/DC.
- Voltage rating: 250V AC/DC

UNLESS OTHERWISE SPECIFIED TOLERANCES
 3 PLACE ±0.5 ±0.10
 2 PLACE ±1.5 ±0.35
 1 PLACE ±2.0 ±0.50
 ANGLE DIM



REV.	REVISION			DIS	DATE
SCALE	REV.	PAGE	UNIT	mm	
4/1	A	1	THIRD ANGLE PROJECTION		

DWG NO: C7805LB

PART.NO: 7805xxLB051