

10

9

8

7

6

5

4

3

2

1

PART NO. 6608xxHF051
 DWG NO. C6608HF

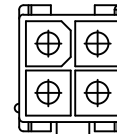
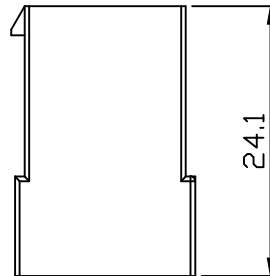
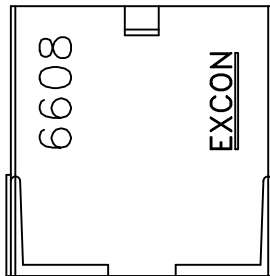
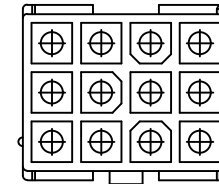
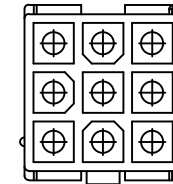
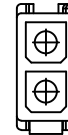
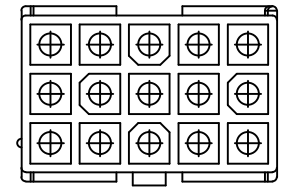
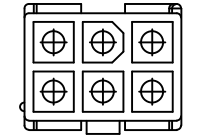
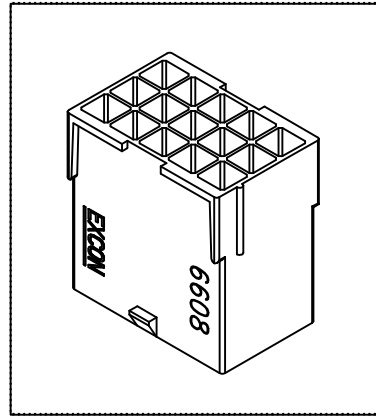
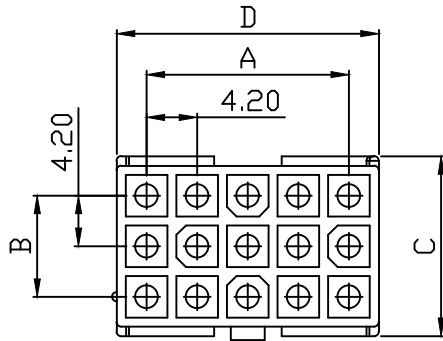

Dimensional & Ordering Information:

| Part No. | Circuits | Dim A | Dim B | Dim C | Dim D |
|-------------|----------|-------|-------|-------|-------|
| 660801HF051 | 1 | --- | --- | 8.2 | 5.6 |
| 660802HF051 | 2 | --- | 4.2 | 12.4 | 5.6 |
| 660803HF051 | 3 | --- | 8.4 | 16.6 | 5.6 |
| 660804HF051 | 4 | 4.2 | 4.2 | 12.4 | 9.8 |
| 660806HF051 | 6 | 8.4 | 4.2 | 12.4 | 14.0 |
| 660809HF051 | 9 | 13.4 | 13.4 | 16.6 | 14.0 |
| 660812HF051 | 12 | 12.6 | 8.4 | 16.6 | 18.2 |
| 660815HF051 | 15 | 16.8 | 8.4 | 16.6 | 22.4 |

NOTE:

- Housing Material:Nylon 66 UL94V2 or V0
- Color: Natural
- Withstand voltage: 1500V AC/minute.
- Current rating: 5A AC/DC.
- Voltage rating: 600V AC/DC

UNLESS OTHERWISE SPECIFIED TOLERANCES
 3 PLACE ±0.5 ±0.10
 2 PLACE ±1.5 ±0.25
 1 PLACE ±2.0 ±0.50
 ANGLE DIM



EXCON TECHNOLOGY COMPANY

| REV. | REVISION | DIS | DATE | DWG NO: | PART.NO |
|------|----------|-----|------------------------|---------|-------------|
| NONE | B | 1 | THIRD ANGLE PROJECTION | C6608HF | 6608xxHF051 |

A

B

C

D

E

F

10

9

8

7

6

5

4

3

2

1

A

B

C

D

E

F