

PART NO. 6607xx09HF051
 DWG NO. C6607HF

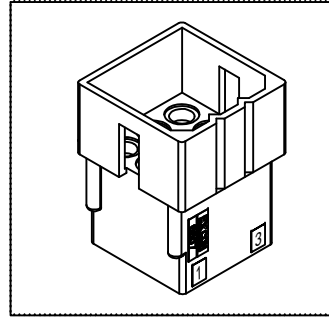

Dimensional & Ordering Information:

Part No.	Circuits	Dim A	Dim B	Dim C	Dim D
660702HF051	2	5.03	--	8.6	13.63
660703HF051	3	10.06	--	8.6	18.66
660704HF051	4	15.09	--	8.6	23.69
6607A4HF051	4	5.03	5.03	13.63	13.63
660705HF051	5	20.12	--	8.6	28.72
660706HF051	6	5.03	10.06	18.66	13.63
660709HF051	9	10.06	10.06	18.66	18.66
660712HF051	12	15.09	10.06	18.66	23.69
660715HF051	15	20.12	10.06	18.66	28.72

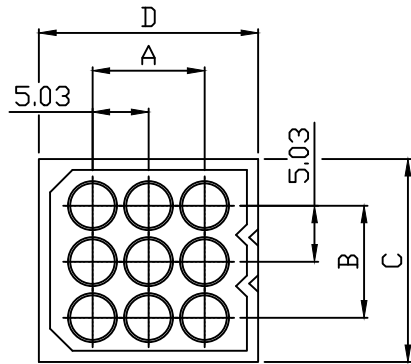
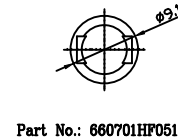
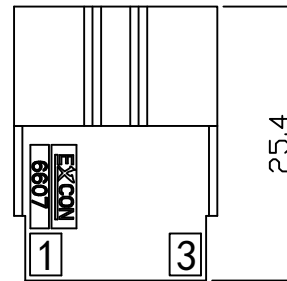
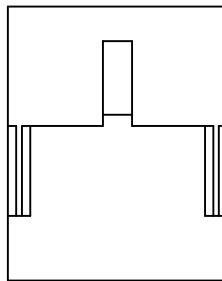

Part No.: 660701HF051



Part No.: 660702HF051



Part No.: 660703HF051



Part No.: 660704HF051



Part No.: 660705HF051



Part No.: 6607A4HF051

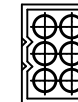

Part No.: 660706HF051

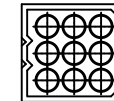

Part No.: 660709HF051

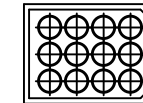

Part No.: 660712HF051

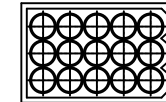

Part No.: 660715HF051

NOTE:

1. Housing Material: Nylon 66 UL94V2
2. Color: Natural
3. Withstand voltage: 1500V AC/minute.
4. Current rating: 5A AC/DC.
5. Voltage rating: 600V AC/DC

				UNLESS OTHERWISE SPECIFIED TOLERANCES		 EXCON TECHNOLOGY COMPANY
				3 PLACE ±0.5 ±0.10		
				2 PLACE ±1.5 ±0.25		
				1 PLACE ±2.0 ±0.50		
REV.	REVISION			DIS	DATE	
SCALE	REV.	PAGE	UNIT	mm		DWG NO:
4/1	A	1	THIRD ANGLE PROJECTION			C6607HF
						PART.NO
						6607xxHF051