

PART NO. 6606xxHM051  
 DWG NO. C6606HM

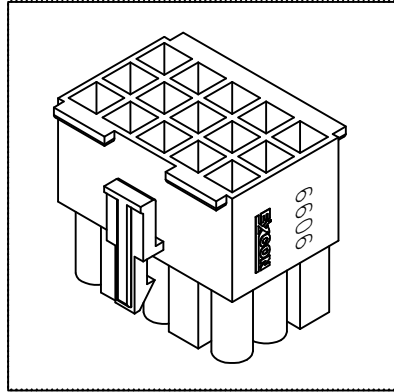

E  
D  
C  
B  
A

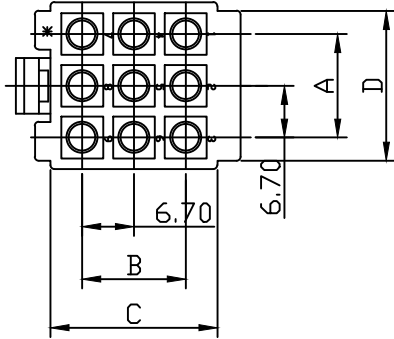
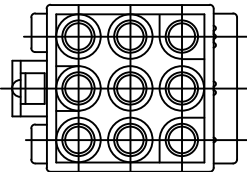
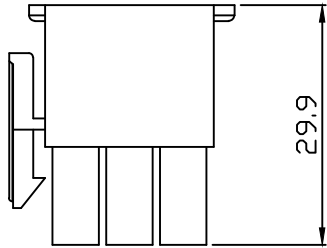
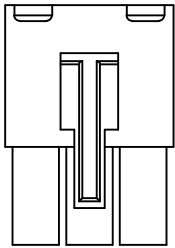

Dimensional & Ordering Information:

Part No.	Circuits	Dim A	Dim B	Dim C	Dim D
660601HM051	1	--	--	7.6	7.6
660602HM051	2	6.7	--	7.6	14.3
660603HM051	3	13.4	--	7.6	21.0
660604HM051	4	20.1	--	7.6	27.7
660606HM051	6	13.4	6.7	14.3	21.0
660609HM051	9	13.4	13.4	21.0	21.0
660612HM051	12	20.1	13.4	21.0	27.7
660615HM051	15	26.8	13.4	21.0	34.4

660601HM051

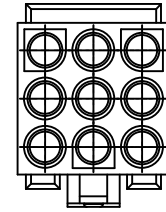

660609HM051

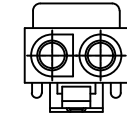

660602HM051

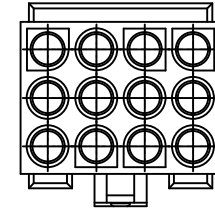

660612HM051

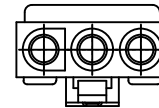

660603HM051

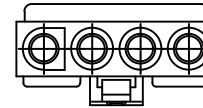

660604HM051

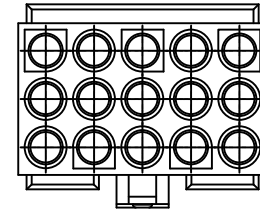

660615HM051

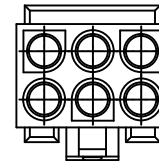

660606HM051

NOTE:

1. Housing Material: Nylon 66 UL94V2
2. Color: Natural
3. Withstand voltage: 1500V AC/minute.
4. Current rating: 5A AC/DC.
5. Voltage rating: 600V AC/DC

UNLESS OTHERWISE SPECIFIED TOLERANCES  
 3 PLACE ±0.5 ±0.10  
 2 PLACE ±1.5 ±0.25  
 1 PLACE ±2.0 ±0.50  
 ANGLE DIM

**EXCON**  
 EXCON TECHNOLOGY COMPANY

REV.	REVISION		DIS	DATE
SCALE	REV.	PAGE	UNIT	m m
NONE	B	1	THIRD ANGLE PROJECTION	

DWG NO:

PART.NO

C6606HM

6606xxHM051

10 9 8 7 6 5 4 3 2 1