

10 9 8 7 6 5 4 3 2 1

PART NO. 6606xxHF051  
 DWG NO. C6606HF

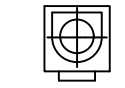

660601HF051

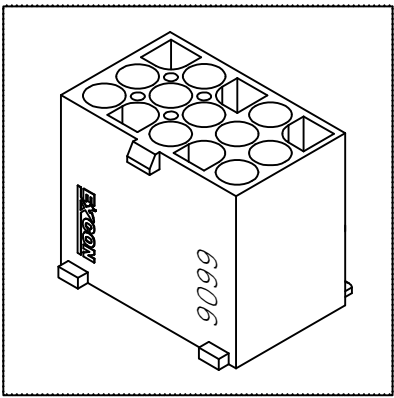
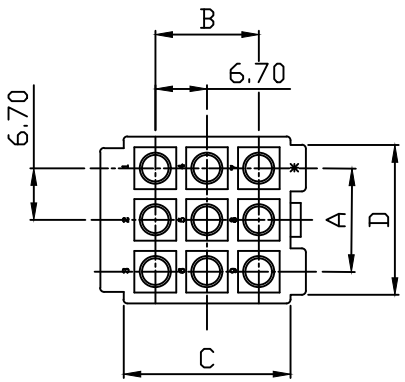
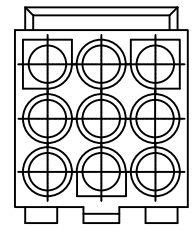

660609HF051

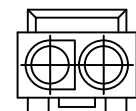

660602HF051

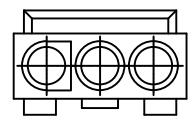

660603HF051

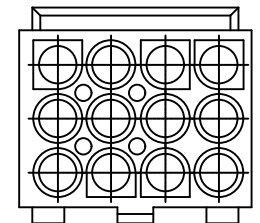

660612HF051

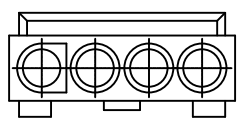

660604HF051

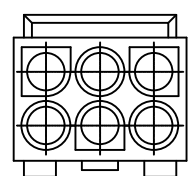

660606HF051

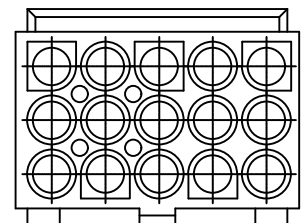

660615HF051

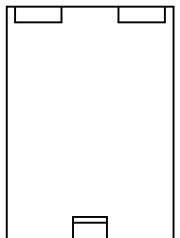
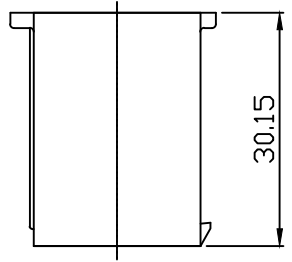

**Dimensional & Ordering Information:**

Part No.	Circuits	Dim A	Dim B	Dim C	Dim D
660601HF051	1	---	---	8.15	8.15
660602HF051	2	6.7	---	8.15	14.85
660603HF051	3	13.4	---	8.15	21.55
660604HF051	4	20.1	---	8.15	28.25
660606HF051	6	13.4	6.7	15.35	21.55
660609HF051	9	13.4	13.4	22.05	21.55
660612HF051	12	20.1	13.4	22.05	28.25
660615HF051	15	26.8	13.4	22.05	34.95

**NOTE:**

- Housing Material: Nylon 66 UL94V2
- Color: Natural
- Withstand voltage: 1500V AC/minute.
- Current rating: 5A AC/DC.
- Voltage rating: 600V AC/DC

UNLESS OTHERWISE SPECIFIED TOLERANCES  
 3 PLACE ±0.5 ±0.10  
 2 PLACE ±1.5 ±0.25  
 1 PLACE ±2.0 ±0.50  
 ANGLE DIM



REV.	REVISION		DIS	DATE
SCALE	REV.	PAGE:	UNIT	m m
NONE	B	1	THIRD ANGLE PROJECTION	

DWG NO: C6606HF

PART.NO 6606xxHF051

10 9 8 7 6 5 4 3 2 1