

PART NO. 6603xxHP051
 DWG NO. C6603HP

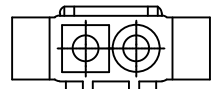

Part No.: 660302HP001

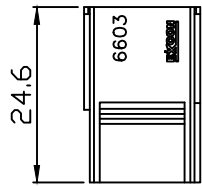
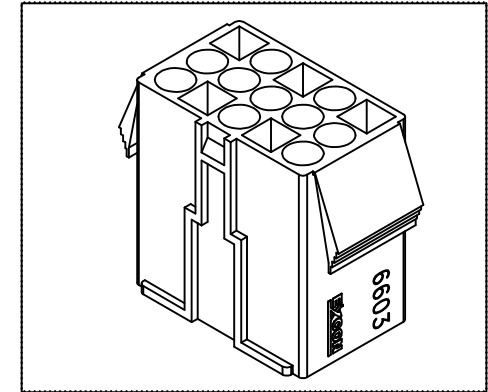
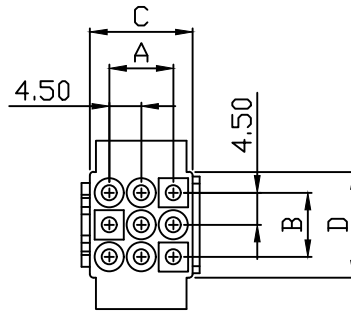
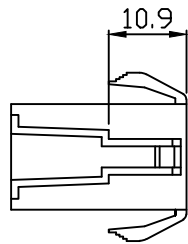
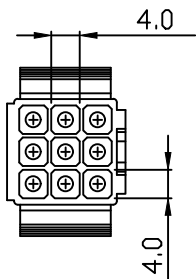
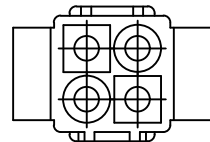

Part No.: 660304HP001

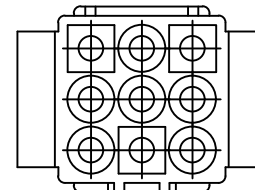

Part No.: 660309HP001

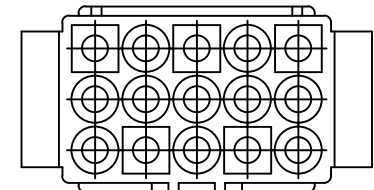

Part No.: 660315HP001

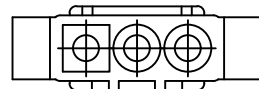

Part No.: 660303HP001

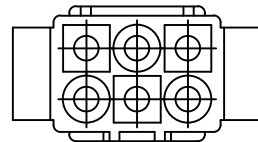

Part No.: 660306HP001

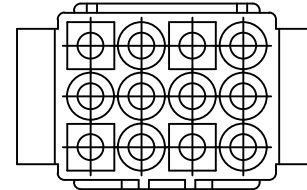

Part No.: 660312HP001

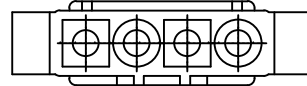

Part No.: 660304HP001

Dimensional & Ordering Information:

Part No.	Circuits	Dim A	Dim B	Dim C	Dim D
660302HP001	2	4.5	--	5.6	10.3
660303HP001	3	9.0	--	5.6	14.8
660304HP001	4	13.5	--	5.6	19.3
6603A4HP001	4	4.5	4.5	10.3	10.3
660306HP001	6	9.0	4.5	10.3	14.8
660309HP001	9	9.0	9.0	14.8	14.8
660312HP001	12	13.5	9.0	14.8	19.3
660315HP001	15	18.0	9.0	14.8	23.8

NOTE:

1. Housing Material: Nylon 66 UL94V-0
2. Insulation resistance: 1000MΩ /min.
3. Withstand voltage: 1500V AC/minute.
4. Current rating: 5A AC/DC.
5. Voltage rating: 600V AC/DC

				UNLESS OTHERWISE SPECIFIED TOLERANCES		 EXCON TECHNOLOGY COMPANY
				3 PLACE ±0.5 ±0.10		
				2 PLACE ±1.5 ±0.25		PART.NO
				1 PLACE ±2.0 ±0.50		
				ANGLE DIM		6603xxHP051
REV.	REVISION		DIS	DATE	DWG NO: C6603HP	
SCALE	REV.	PAGE:	UNIT	mm	PART.NO	
NONE	B	1	THIRD ANGLE PROJECTION		6603xxHP051	