

PART NO. 6602xxHD051  
 DWG NO. C6602HD

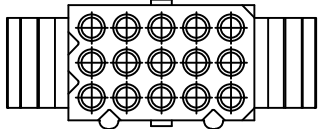
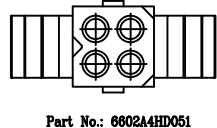
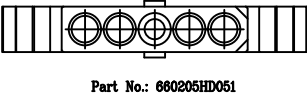
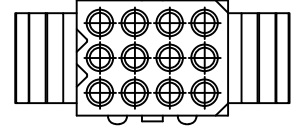
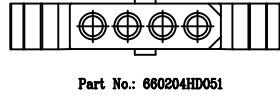
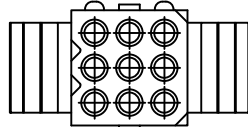
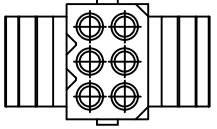
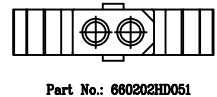
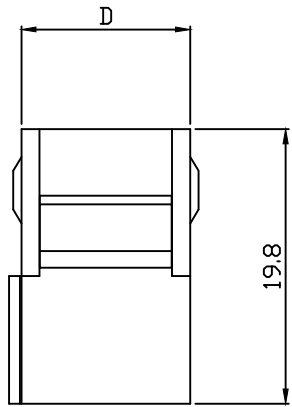
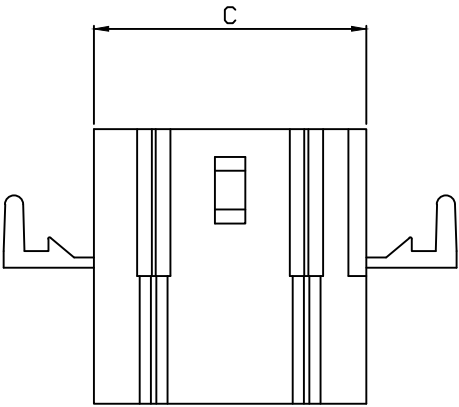
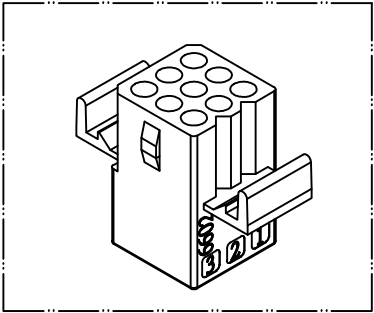
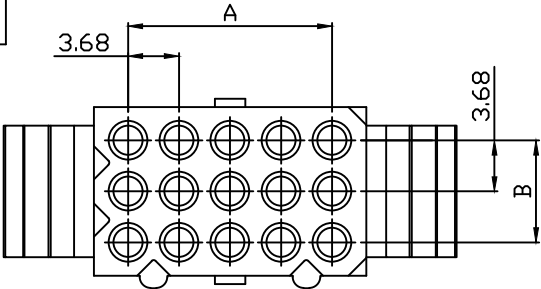

Dimensional & Ordering Information:

Part No.	Circuits	Dim A	Dim B	Dim C	Dim D
660202HD051	2	3.68	--	8.64	4.88
660203HD051	3	7.36	--	12.32	4.88
660204HD051	4	11.04	--	16.0	4.88
660205HD051	5	14.72	--	19.68	4.88
6602A4HD051	4	3.68	3.68	8.64	8.64
660206HD051	6	3.68	7.36	8.64	12.32
660209HD051	9	7.36	7.36	12.32	12.32
660212HD051	12	11.04	7.36	16.0	12.32
660215HD051	15	14.72	7.36	19.68	12.42

- NOTE:
- Housing Material: Nylon 66 UL94V-2
  - Color: Natural
  - Insulation resistance: 1000M<sub>Ω</sub> min.
  - Withstand voltage: 1500V AC/minute.
  - Current rating: 5A AC/DC.
  - Voltage rating: 6000V AC/DC

REV.	REVISION	DIS	DATE	UNLESS OTHERWISE SPECIFIED TOLERANCES 3 PLACE ±0.5 ±0.10 2 PLACE ±1.5 ±0.25 1 PLACE ±2.0 ±0.50 ANGLE DIM	 <b>EXCON TECHNOLOGY COMPANY</b>
SCALE	REV.	PAGE	UNIT	DWG NO:	
1/1	A	1/1	THIRD ANGLE PROJECTION	C6602HD	PART NO 6602xxHD051