

PART NO.  
4201xxWHOxx  
DWG NO.  
C4201WH

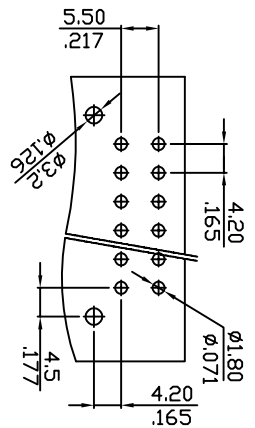
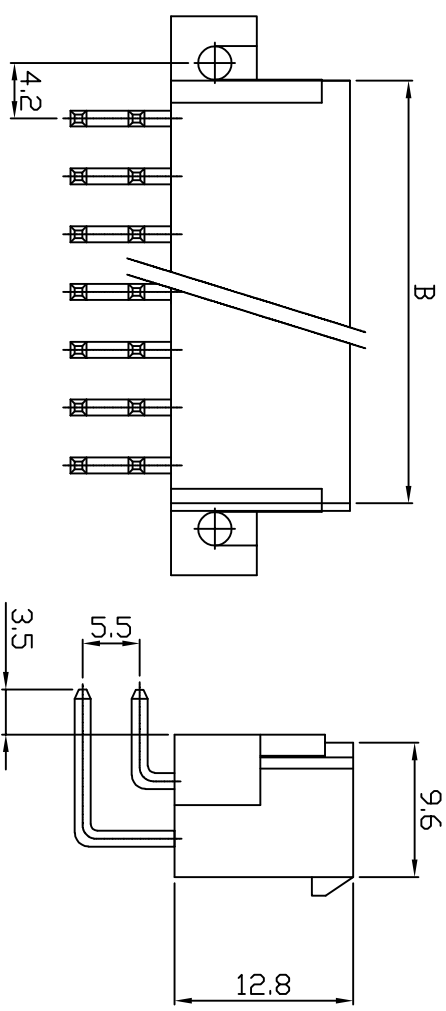
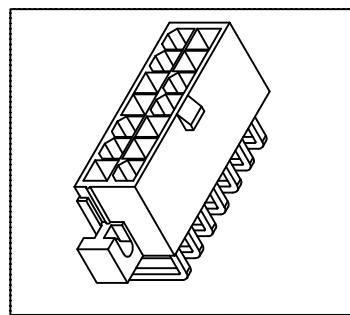
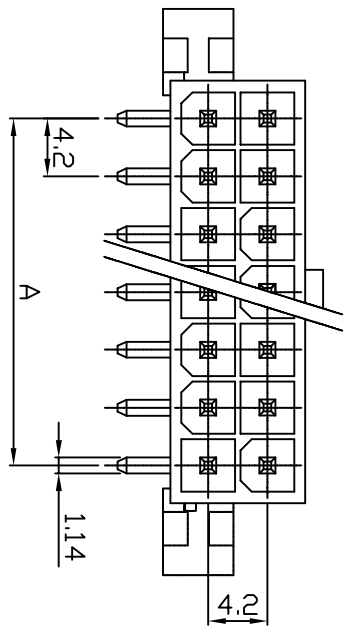

RECOMMENDED PCB LAYOUT  
(PCB T=1.0~1.6mm)  
(PCB T=.039~.063in)

Dimensional & Ordering Information:

Part No.	NY66 UL94V2	Circuits	A	B
NY66 UL94V0	NY66 UL94V2	2	4.2	5.4
420102WH001	420102WH051	4	4.2	9.6
420104WH001	420104WH051	6	8.4	13.8
420106WH001	420106WH051	8	12.6	18.0
420108WH001	420108WH051	10	16.8	22.2
420110WH001	420110WH051	12	21.0	26.4
420112WH001	420112WH051	14	25.2	30.6
420114WH001	420114WH051	16	29.4	34.8
420106WH001	420106WH051	18	33.6	39.0
420118WH001	420118WH051	20	37.8	43.2
420120WH001	420120WH051	22	42.0	47.4
420122WH001	420122WH051	24	46.2	51.6

- NOTE:
1. Wafer Material: Nylon 66 UL94V2 or V0
  2. Pin/Pos Material: brass bronze.
  3. Plated: Tin-plated 50u"min.
  4. Insulation resistance: 1000M ohm/min.
  5. Withstand voltage: 1500V AC/minute.
  6. Current retang: 5A AC/DC.
  7. Voltage rating: 600V AC/DC

UNLESS OTHERWISE SPECIFIED TOLERANCES  
3 PLACE ±0.5 ±0.10  
2 PLACE ±1.5 ±0.25  
1 PLACE ±2.0 ±0.50  
ANGLE DIM



REV.	REVISION	DIS	DATE	DWG NO:	PART NO
2/1	A	1	THIRD ANGLE PROJECTION	C4201WH	4201xxWHOxx

