

PART NO.
4201xxHP0xx
DWG NO.
C4201HP

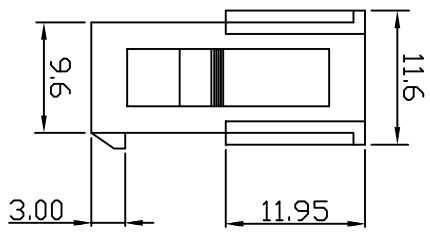
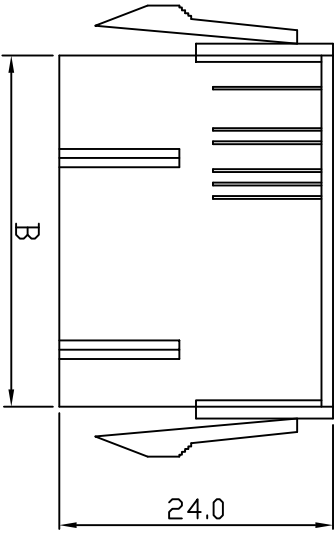
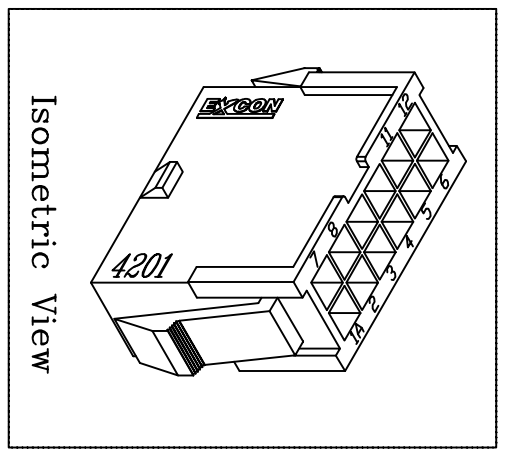
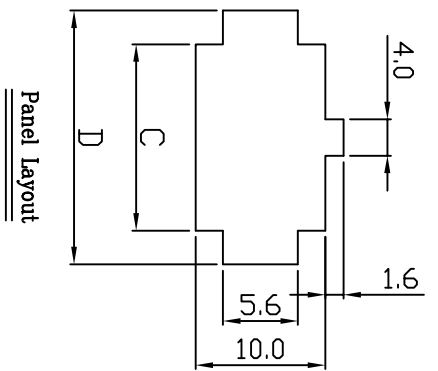
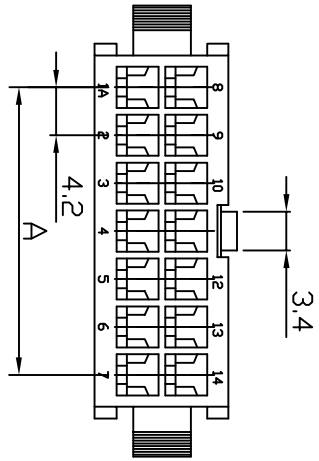

Dimensional & Ordering Information:

Part No.	NY66 UL94V0	NY66 UL94V2	Circuits	A	B	C	D
420102HP001	420102HP051	420102HP051	2	5.4	5.8	10.8	10.8
420104HP001	420104HP051	420104HP051	4	4.2	9.6	10.0	15.0
420106HP001	420106HP051	420106HP051	6	8.4	13.8	14.2	19.2
420108HP001	420108HP051	420108HP051	8	12.6	18.0	18.4	23.4
420110HP001	420110HP051	420110HP051	10	16.8	22.2	22.6	27.6
420112HP001	420112HP051	420112HP051	12	21.0	26.4	26.8	31.8
420114HP001	420114HP051	420114HP051	14	25.2	30.6	31.1	36.0
420106HP001	420106HP051	420106HP051	16	29.4	34.8	35.3	40.2
420118HP001	420118HP051	420118HP051	18	33.6	39.0	39.5	44.4
420120HP001	420120HP051	420120HP051	20	37.8	43.2	43.7	48.6
420122HP001	420122HP051	420122HP051	22	42.0	47.4	47.9	52.8
420124HP001	420124HP051	420124HP051	24	46.2	51.6	52.1	57.0

- NOTE:
1. Wafer Material: Nylon 66 UL94V2 or V0
 2. Insulation resistance: 1000M ohm/min.
 3. Withstand voltage: 1500V AC/minute.
 4. Current relang: 5A AC/DC.
 5. Voltage rating: 600V AC/DC
 6. Color : Natural



EXCON TECHNOLOGY COMPANY

SCALE	REV.	PAGE:	UNIT	PROJECTION	DWG NO:	PART NO
2/1	B	1/1	mm	THIRD ANGLE	C4201HP	4201xxHP0xx
UNLESS OTHERWISE SPECIFIED TOLERANCES						
3 PLACE ±0.5 ±0.10						
2 PLACE ±1.5 ±0.25						
1 PLACE ±2.0 ±0.50						
ANGLE DIM						

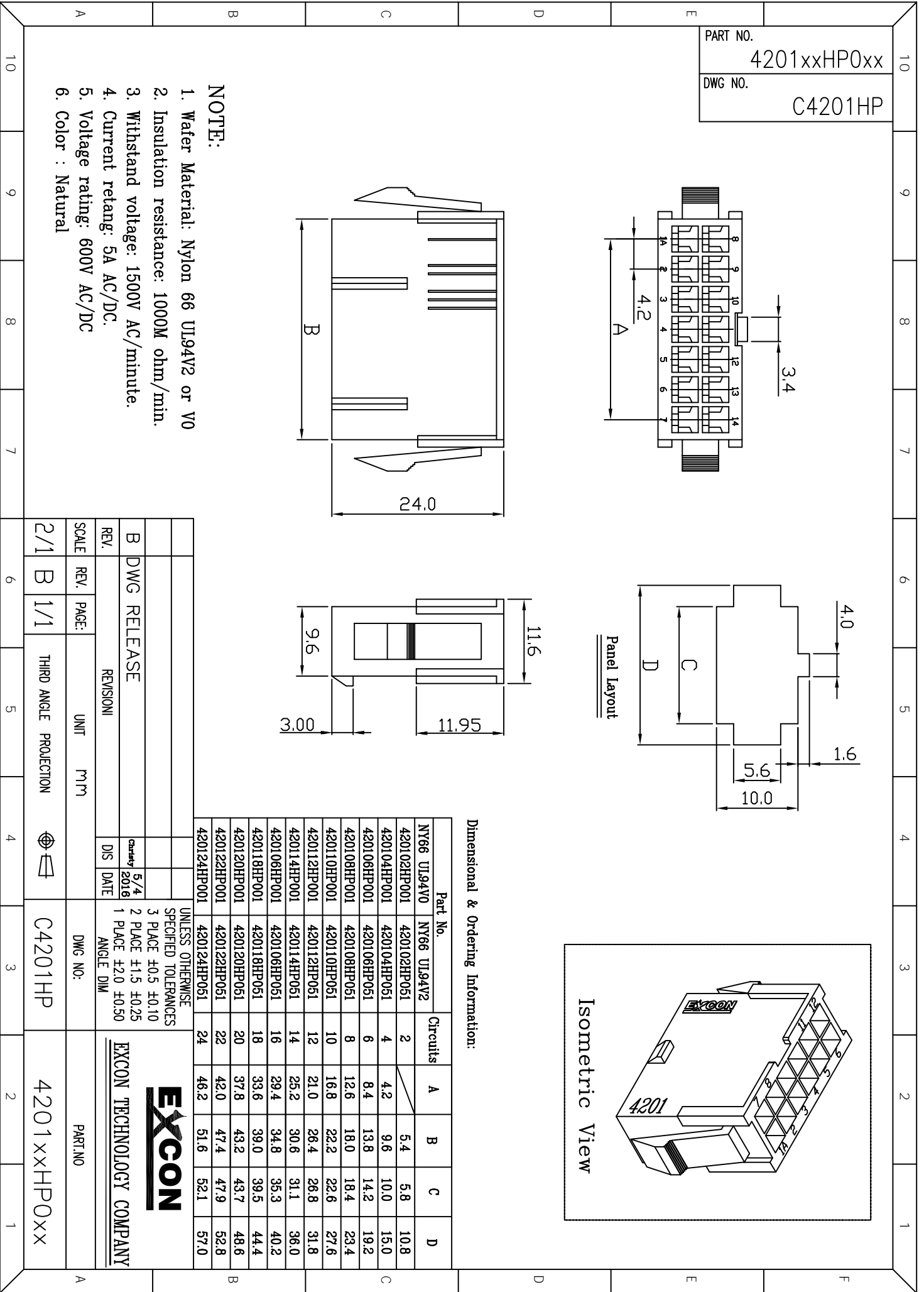

PART NO.
4201xxHP0xx
DWG NO.
C4201HP

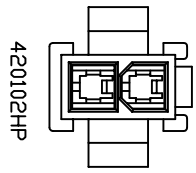

420102HP

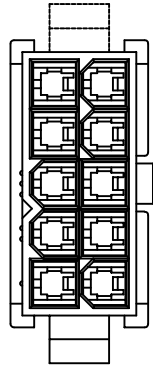

420110HP

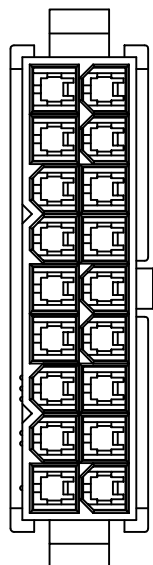

420118HP

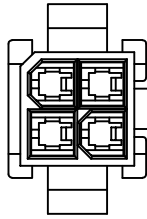

420104HP

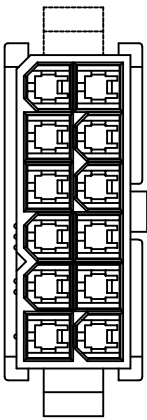

420112HP

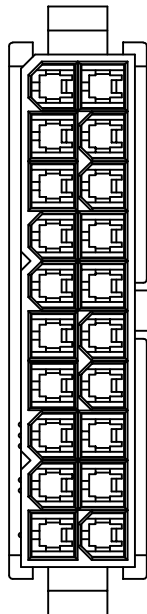

420120HP

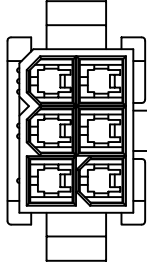

420106HP

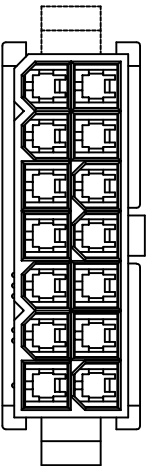

420114HP

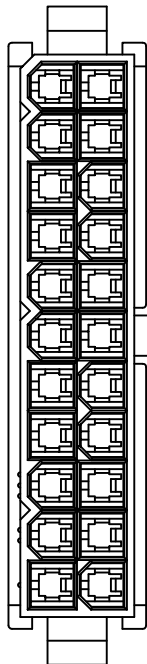

420122HP

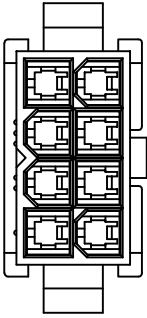

420108HP

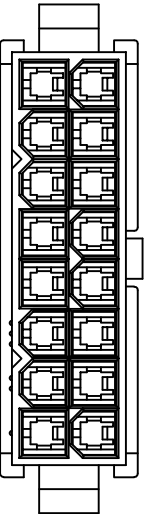

420116HP

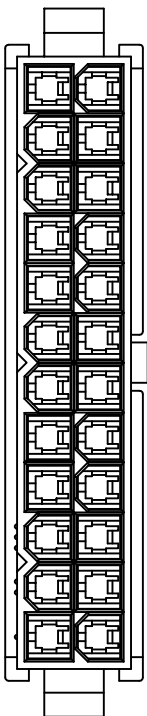

420124HP

UNLESS OTHERWISE
SPECIFIED TOLERANCES
3 PLACE ± 0.5 ± 0.10
2 PLACE ± 1.5 ± 0.25
1 PLACE ± 2.0 ± 0.50
ANGLE DIM



EXCON TECHNOLOGY COMPANY

REV.	REVISION	UNIT	DIS	DATE	DWG NO:	PART NO
2/1	A	2/2	THIRD ANGLE PROJECTION		C4201HP	4201xxHP0xx
SCALE	REV.	PAGE:	UNIT	m/m		

