

PART NO. 3971xxHA208  
 DWG NO. C3971HA

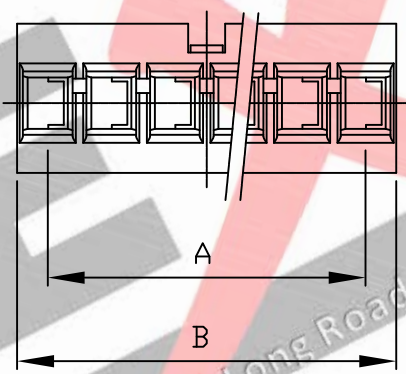
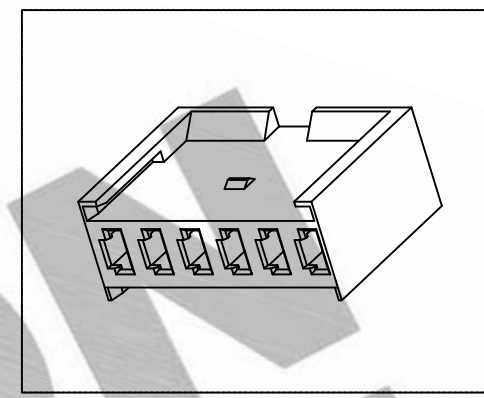
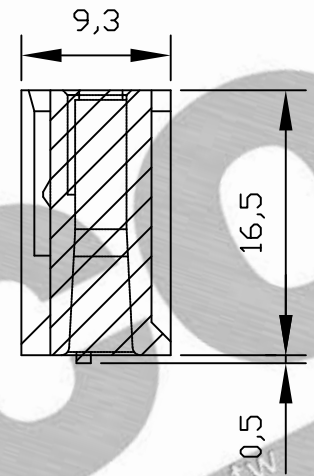
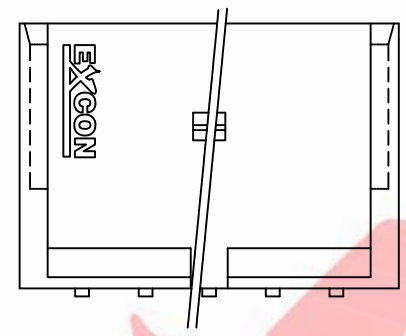
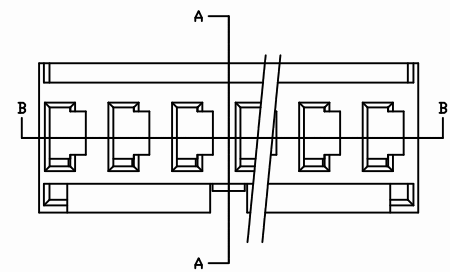

NOTE:

1. Housing Material: PBT UL94V-0
2. Insulation resistance: 1000M ohm/min.
3. Withstand voltage: 1500V AC/minute.
4. Current rating: 5A AC/DC.
5. Voltage rating: 250V AC/DC

Dimensional & Ordering Information:

Part No.	Circuits	Dim A	Dim B
397102HA208	2	3.96	7.78
397104HA208	4	11.88	15.70
397106HA208	6	19.80	23.62
397108HA208	8	27.72	31.54
397110HA208	10	35.64	39.46
397112HA208	12	43.56	47.38

UNLESS OTHERWISE SPECIFIED TOLERANCES			
3 PLACE ±0.5 ±0.10			
2 PLACE ±1.5 ±0.25			
1 PLACE ±2.0 ±0.50			
ANGLE DIM			
REV.	REVISION		DIS DATE
SCALE	REV.	PAGE:	UNIT mm
2/1	A	1	THIRD ANGLE PROJECTION
DWG NO:			C3971HA

**EXCON**  
 EXCON TECHNOLOGY COMPANY

PART.NO  
 3971xxHA208

