

PART NO. 396100TD001
 DWG NO. C3961TD

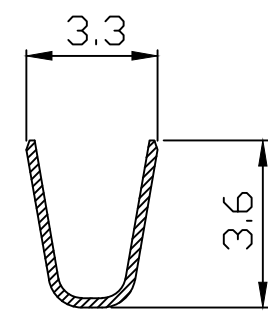

SEC A-A

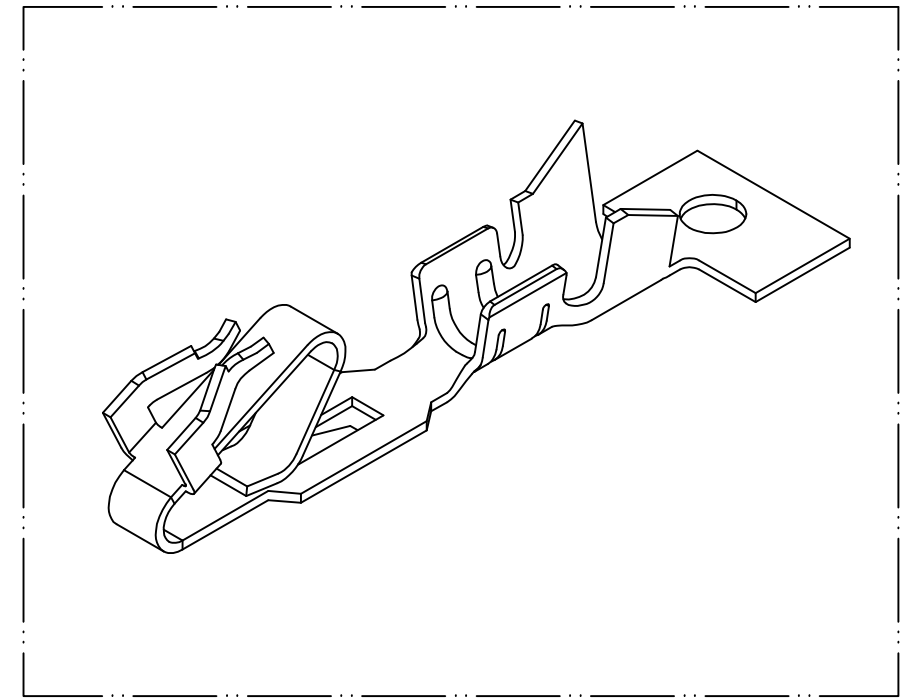
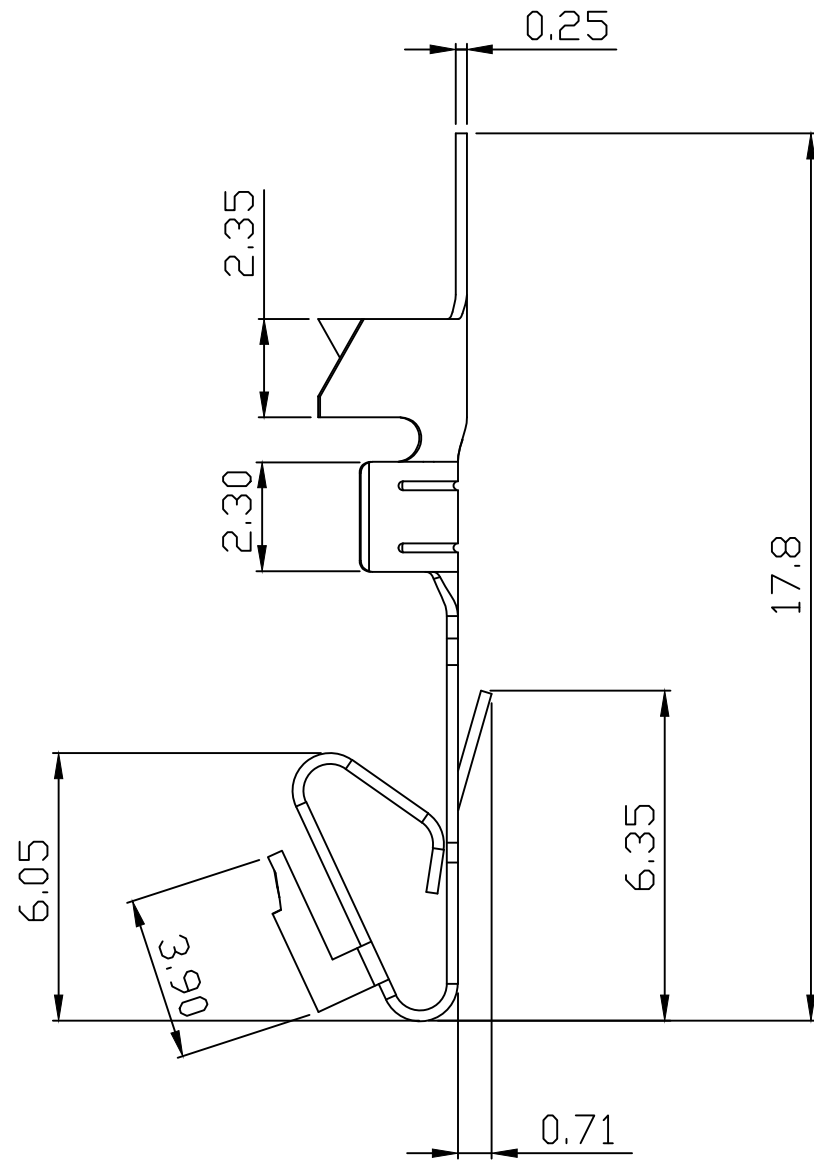
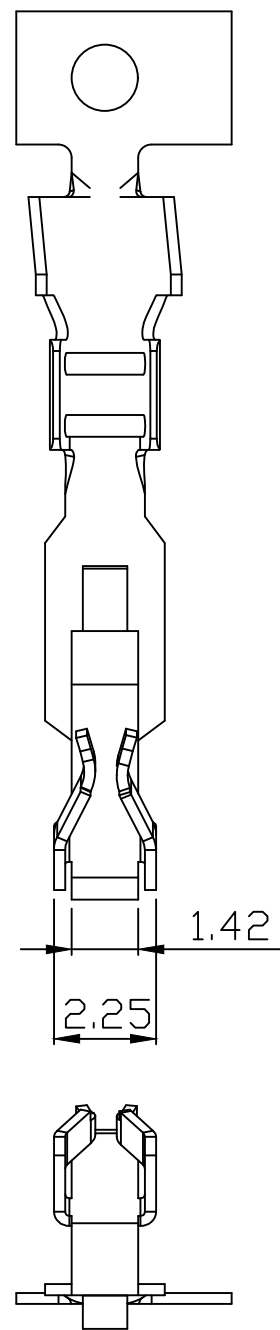
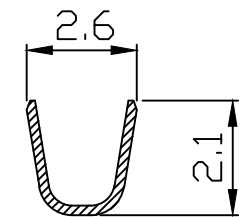

SEC B-B

NOTE:

1. Terminal Material: Brass bronze
2. Plated: Tin-plated 50u"min.
3. Applicable wires: AWG#18-#24
4. Insulation O.D.: 1.2-2.8mm
5. Q'ty / reel: 7,000 pcs

REV.	REVISION		DIS	DATE
4/1	A	1		

UNLESS OTHERWISE SPECIFIED TOLERANCES
 3 PLACE ±0.5 ±0.10
 2 PLACE ±1.5 ±0.25
 1 PLACE ±2.0 ±0.50
 ANGLE DIM

EXCON
 EXCON TECHNOLOGY COMPANY

SCALE	REV.	PAGE:	UNIT	mm
4/1	A	1	THIRD ANGLE PROJECTION	

DWG NO: C3961TD

PART.NO 396100TD001