

10 9 8 7 6 5 4 3 2 1

PART NO. 254200TC051  
 DWG NO. C2542TC

F  
 E  
 D  
 C  
 B  
 A

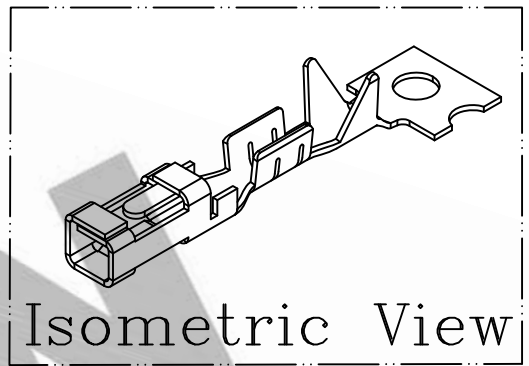
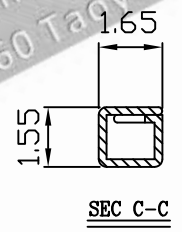
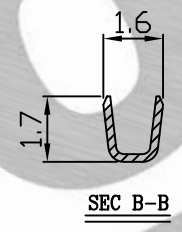
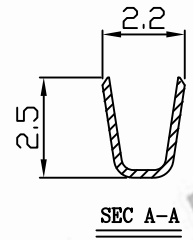
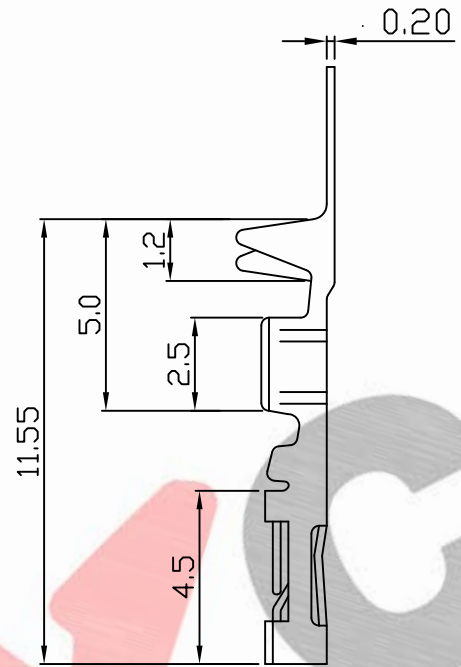
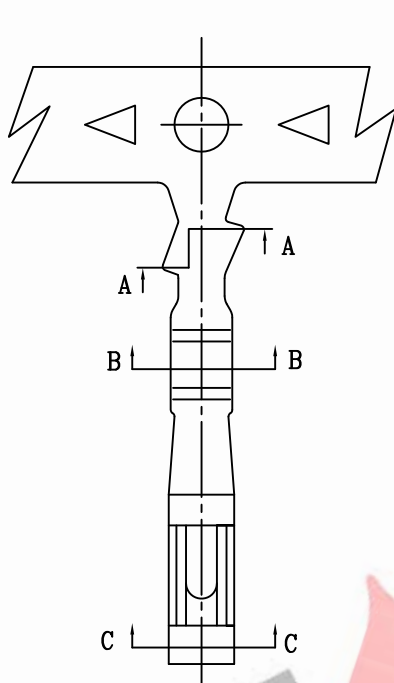

NOTE:

- 1. Terminal Material: Brass bronze
- 2. Plated: Tin pre-plated 50u"min.
- △ 3. Current rating: 3A AC/DC
- △ 4. Voltage rating: 250V AC/DC
- △ 5. Withstand voltage: 1000V AC/minute
- △ 6. Insulation resistance: 1000MΩ min
- △ 7. Applicable wires: AWG#30-#24
- △ 8. Insulation O.D.: 0.9~1.5mm
- 9. Q'ty / reel: 10,000pcs

REV.		REVISIONI		DIS	DATE
SCALE	REV.	PAGE:	UNIT	mm	
4/1	B	1/1	THIRD ANGLE PROJECTION		

UNLESS OTHERWISE SPECIFIED TOLERANCES  
 3 PLACE ±0.5 ±0.10  
 2 PLACE ±1.5 ±0.25  
 1 PLACE ±2.0 ±0.50  
 ANGLE DIM



NOTE:  
 1.修改 第7項 AWG#28-#22 → AWG#30-#24  
 2.修改 第8項 1.2-1.7mm → 0.9-1.5mm  
 3.新增 第3、4、5、6項及鍍厚T0.20

christy 5/26 2015

www.excon.com.tw  
 89, Xing Long Road, Ping Zhen Dist., 32460 Taoyuan City, Taiwan (R.O.C)

DWG NO: C2542TC  
 PART.NO: 254200TC051

10 9 8 7 6 5 4 3 2 1

10 9 8 7 6 5 4 3 2 1

PART NO. 254200TC201  
 DWG NO. C2542TC

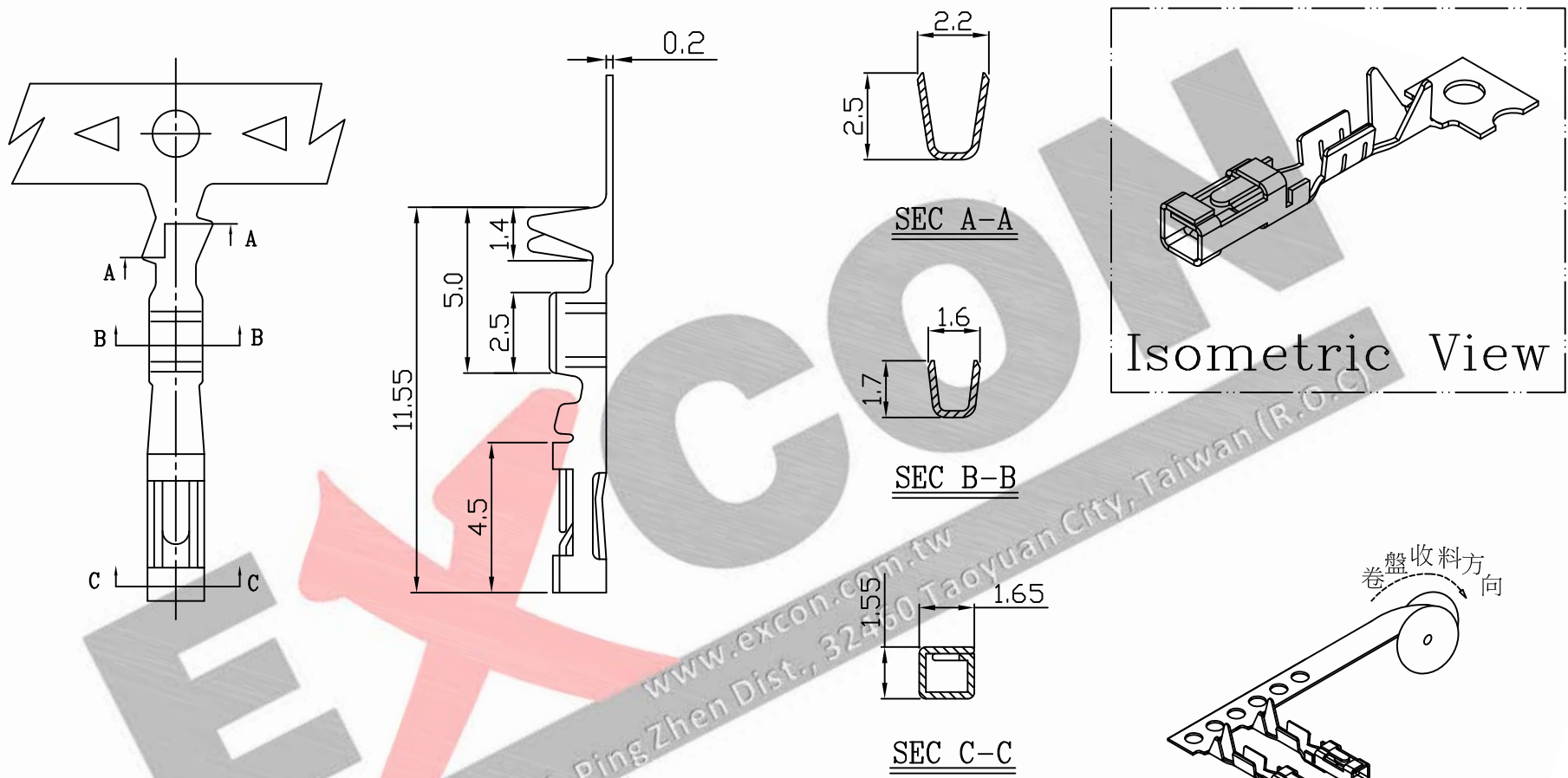

- NOTE:**
1. Terminal Material: Brass bronze
  2. Plated: gold flash plated
  - △ 3. Current rating: 3A AC/DC
  - △ 4. Voltage rating: 250V AC/DC
  - △ 5. Withstand voltage: 1000V AC/minute
  - △ 6. Insulation resistance: 1000MΩ min
  - △ 7. Applicable wires: AWG#30-#24
  - △ 8. Insulation O.D.: 0.9~1.5mm
  9. Q'ty / reel: 10,000pcs

				UNLESS OTHERWISE SPECIFIED TOLERANCES		<b>EXCON</b> EXCON TECHNOLOGY COMPANY
				3 PLACE ±0.5 ±0.10 2 PLACE ±1.5 ±0.25 1 PLACE ±2.0 ±0.50 ANGLE DIM		
B	DWG RELEASE			△ Christy	6/28 2016	
REV.	REVISIONI			DIS	DATE	
SCALE	REV.	PAGE:	UNIT	mm		DWG NO:
4/1	B	1/1	THIRD ANGLE	PROJECTION	⊕	C2542TC
					PART.NO	
					254200TC201	

10 9 8 7 6 5 4 3 2 1