

PART NO. 2510xxWV001  
 DWG NO. C2510WV

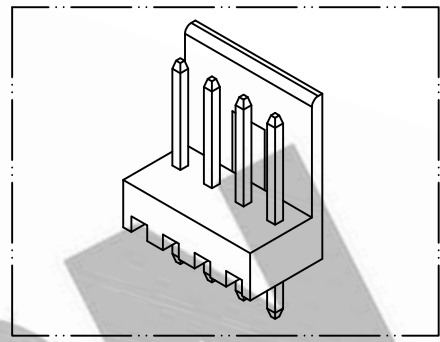

TOLERANCES ARE NON-CUMULATIVE: ±0.05

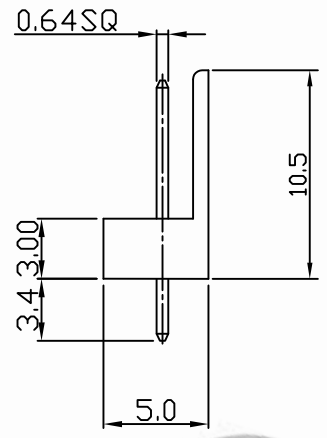
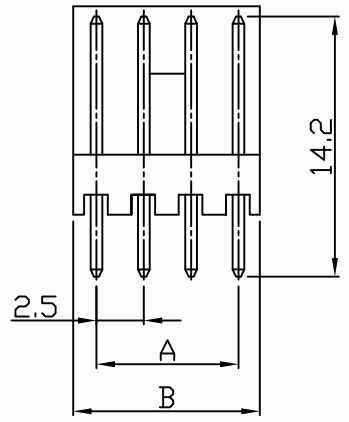
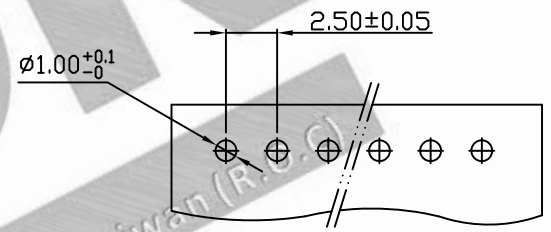

**RECOMMENDED PCB LAYOUT**  
 (PCB THK=1.0~1.6)

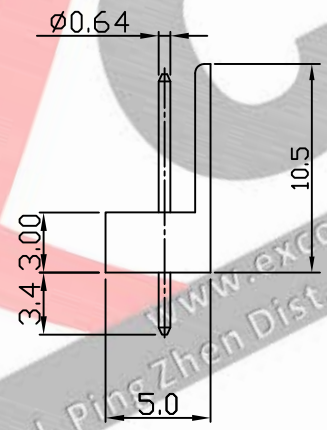
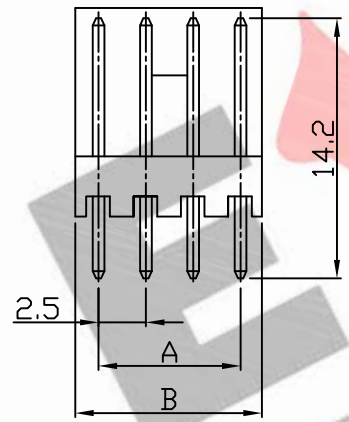

2510xxWT001

**Dimensional & Ordering Information:**

Part No.		Circuits	Dim A	Dim B
PIN:Ø0.64	PIN:SQ0.64			
251002WT001	251002WV001	2	2.50	5.00
251003WT001	251003WV001	3	5.00	7.50
251004WT001	251004WV001	4	7.50	10.00
251005WT001	251005WV001	5	10.00	12.50
251006WT001	251006WV001	6	12.50	15.00
251007WT001	251007WV001	7	15.00	17.50
251008WT001	251008WV001	8	17.50	20.00
251009WT001	251009WV001	9	20.00	22.50
251010WT001	251010WV001	10	22.50	25.00
251011WT001	251011WV001	11	25.00	27.50
251012WT001	251012WV001	12	27.50	30.00

**NOTE:**

1. Wafer Material: Nylon 66 UL94V-0  
Pin/Pos Material: brass bronze.
2. Plated: Tin-plated 50u"min.
3. Insulation resistance: 1000MΩ min.
4. Withstand voltage: 1000V AC/minute.
5. Current rating: 3A AC/DC.
6. Voltage rating: 250V AC/DC

REV.				REVISIONI		DIS	DATE	UNLESS OTHERWISE SPECIFIED TOLERANCES 3 PLACE ±0.5 ±0.10 2 PLACE ±1.5 ±0.25 1 PLACE ±2.0 ±0.50 ANGLE DIM	 <b>EXCON TECHNOLOGY COMPANY</b>
SCALE	REV.	PAGE:	UNIT	mm		DWG NO:			
4/1	A	1	THIRD ANGLE PROJECTION			C2510WV		2510xxWV001	