

PART NO. 2505xxHA054
 DWG NO. C2505HA

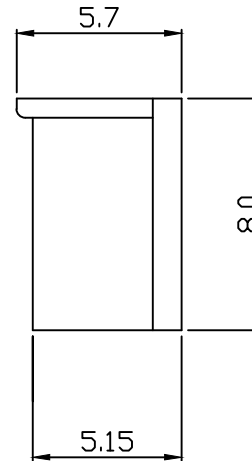
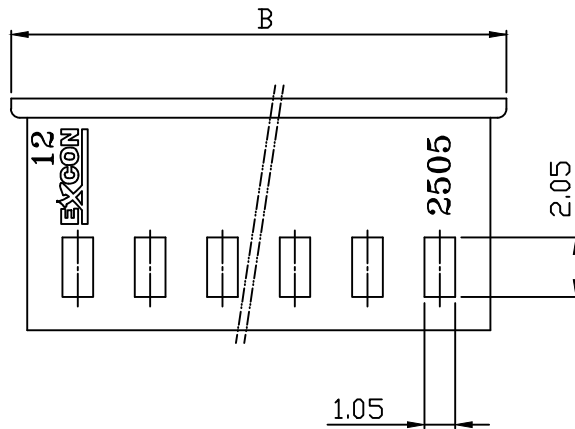
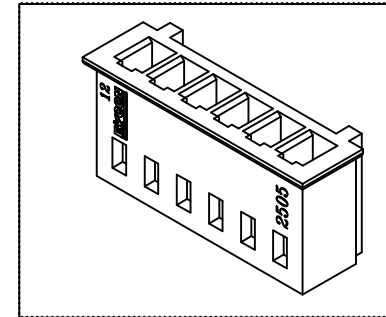
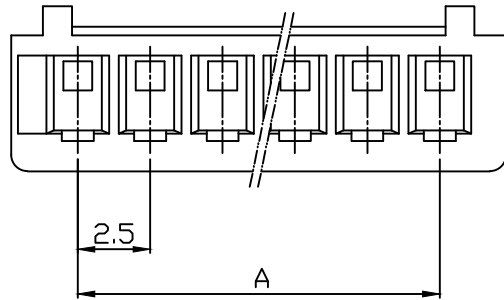

Dimensional & Ordering Information:

Part No.	Circuits	Dim A	Dim B
250502HA054	2	2.50	7.10
250503HA054	3	5.00	9.60
250504HA054	4	7.50	12.10
250505HA054	5	10.00	14.60
250506HA054	6	12.50	17.10
250507HA054	7	15.00	19.60
250508HA054	8	17.50	22.10
250509HA054	9	20.00	24.60
250510HA054	10	22.50	27.10
250511HA054	11	25.00	29.60
250512HA054	12	27.50	32.10
250513HA054	13	30.00	34.60
250514HA054	14	32.50	37.10
250515HA054	15	35.00	39.60
250516HA054	16	37.50	42.10
250517HA054	17	40.00	44.60
250518HA054	18	42.50	47.10
250519HA054	19	45.00	49.60
250520HA054	20	47.50	52.10

NOTE:

1. Housing Material: Nylon 66 UL94V-2
2. Color: Beige
3. Insulation resistance: 1000M Ω min.
4. Withstand voltage: 800V AC/minute.
5. Current rating: 3A AC/DC.
6. Voltage rating: 250V AC/DC

REV.	REVISION	DIS	DATE
4/1	A	1	

UNLESS OTHERWISE SPECIFIED TOLERANCES
 3 PLACE $\pm 0.5 \pm 0.10$
 2 PLACE $\pm 1.5 \pm 0.35$
 1 PLACE $\pm 2.0 \pm 0.50$
 ANGLE DIM

EXCON
 EXCON TECHNOLOGY COMPANY

SCALE	REV.	PAGE	UNIT	mm	DWG NO:	PART.NO
4/1	A	1	THIRD ANGLE PROJECTION		C2505HA	2505xxHA054