

PART NO.
2502xxHA001
DWG NO.
C2502HA

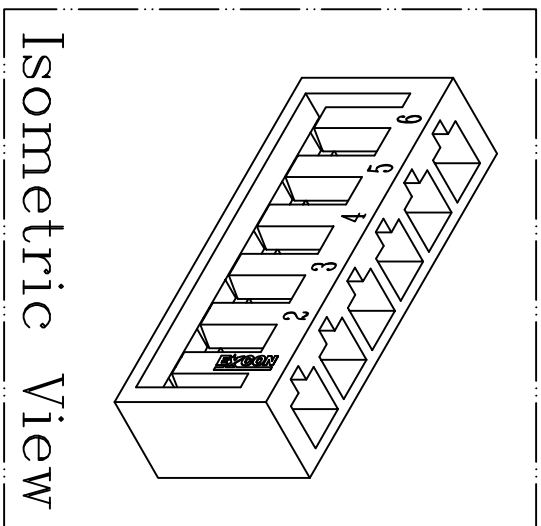
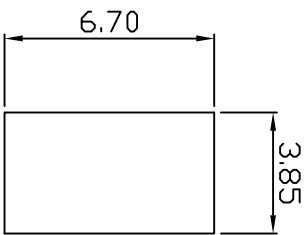
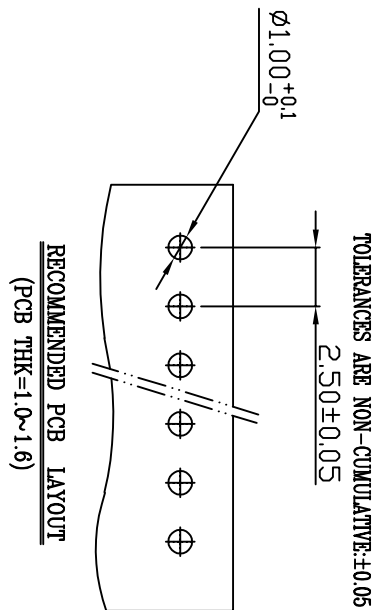
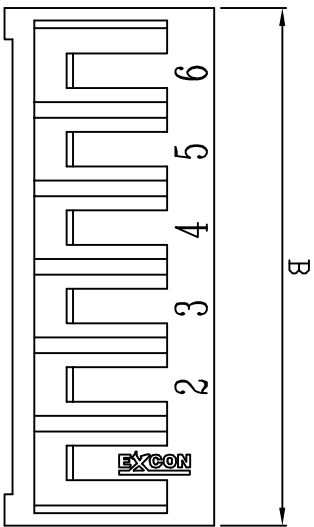
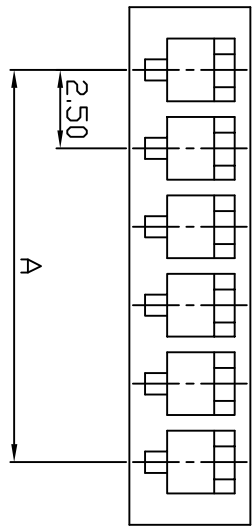

Dimensional & Ordering Information:

Part No.	Circuits	Dim A	Dim B
250202HA001	2	2.50	6.50
250203HA001	3	5.00	9.00
250204HA001	4	7.50	11.50
250205HA001	5	10.00	14.00
250206HA001	6	12.50	16.50
250207HA001	7	15.00	19.00
250208HA001	8	17.50	21.50
250209HA001	9	20.00	24.00
250210HA001	10	22.50	26.50
250211HA001	11	25.00	29.00
250212HA001	12	27.50	31.50
250213HA001	13	30.00	34.00
250214HA001	14	32.50	36.50
250215HA001	15	35.00	39.00
250216HA001	16	37.50	41.50

NOTE:

1. Housing Material: Nylon 66 UI94V-0
2. Current rating: 3A AC/DC.
3. Voltage rating: 250V AC/DC
4. Insulation resistance: 1000M Ω /min.
5. Withstand voltage: 1000V AC/minute.
6. Color: Natural

REV.	B	DWG RELEASE	REVISION	UNIT	m/m	DATE	8/8 2016
SCALE	5/1	B	1/1	THIRD ANGLE PROJECTION			

UNLESS OTHERWISE SPECIFIED TOLERANCES
3 PLACE ± 0.5 ± 0.10
2 PLACE ± 1.5 ± 0.25
1 PLACE ± 2.0 ± 0.50
ANGLE DIM



EXCON TECHNOLOGY COMPANY

PART NO

C2502HA

2502xxHA001

A

10

9

8

7

6

5

4

3

2

1

A

B

C

D

E

F