

PART NO. 1501xxWD101
 DWG NO. C1501WD

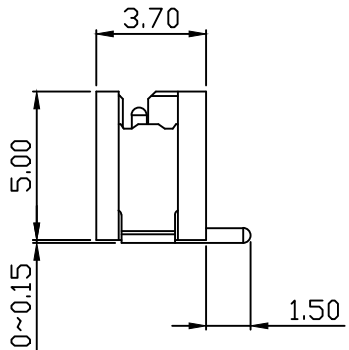
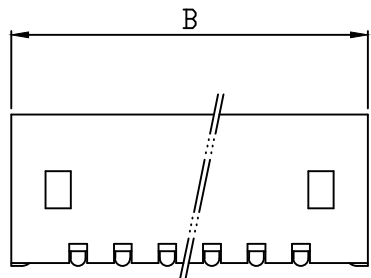
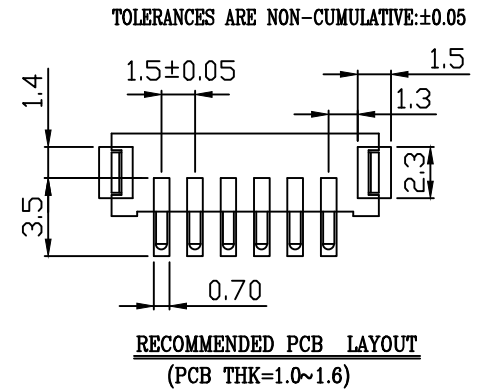
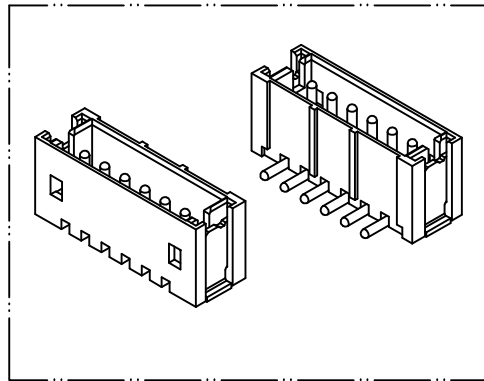
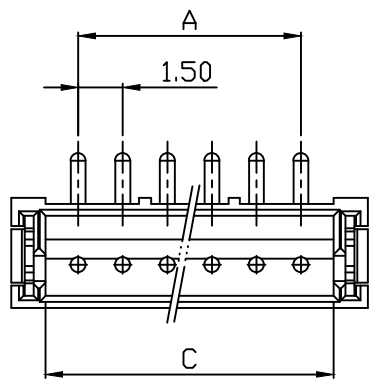

Dimensional & Ordering Information:

Part No.	Circuits	Dim A	Dim B	Dim C
150102WD101	2	1.50	6.00	3.60
150103WD101	3	3.00	7.50	5.10
150104WD101	4	4.50	9.00	6.60
150105WD101	5	6.00	10.50	8.10
150106WD101	6	7.50	12.00	9.60
150107WD101	7	9.00	13.50	11.10
150108WD101	8	10.50	15.00	12.60
150109WD101	9	12.00	16.50	14.10
150110WD101	10	13.50	18.00	15.60
150111WD101	11	15.00	19.50	17.10
150112WD101	12	16.50	21.00	18.60
150113WD101	13	18.00	22.50	20.10
150114WD101	14	19.50	24.00	21.60
150115WD101	15	21.00	25.50	23.10

NOTE:

1. Wafer Material: 6T UL94V-0
Pin/Pos Material: brass bronze.
2. Plated: Tin-plated 50u"min.
3. Insulation resistance: 500MΩ min.
4. Withstand voltage: 500V AC/minute.
5. Current rating: 1A AC/DC.
6. Voltage rating: 100V AC/DC

REV.				REVISION		DIS	DATE	UNLESS OTHERWISE SPECIFIED TOLERANCES 3 PLACE ±0.5 ±0.10 2 PLACE ±1.5 ±0.25 1 PLACE ±2.0 ±0.50 ANGLE DIM	 EXCON TECHNOLOGY COMPANY
SCALE	REV.	PAGE	UNIT	mm		DWG NO:			
5/1	A	1	THIRD ANGLE PROJECTION			C1501WD		1501xxWD101	