

10 9 8 7 6 5 4 3 2 1

PART NO. 125100TCxxx  
 DWG NO. C1251TC

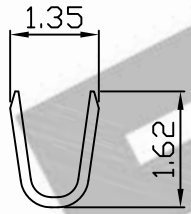

SEC A-A

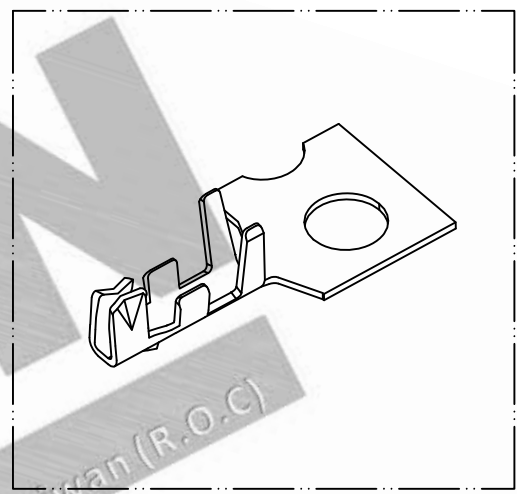
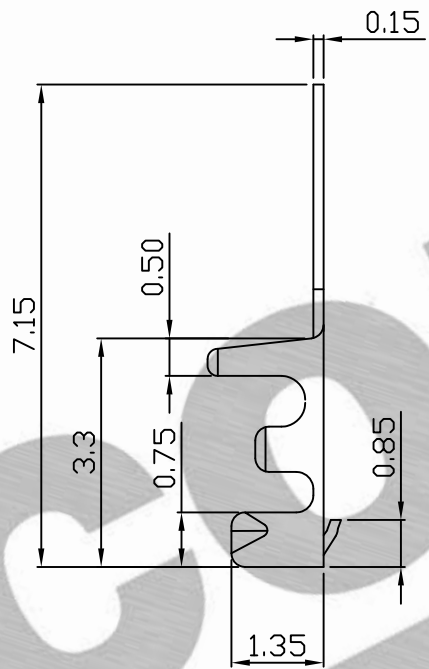
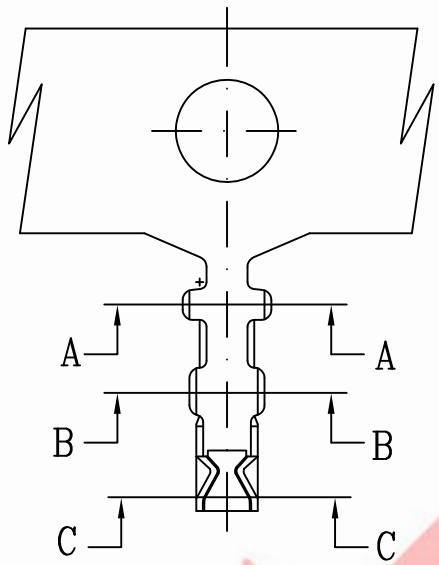
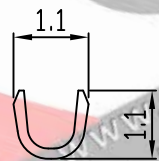

SEC B-B

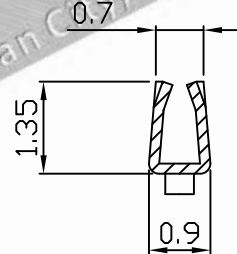

SEC C-C

- NOTE:
1. Terminal Material: phosphor
  2. Plated: Tin plated 50u"min.
  3. Applicable wires: AWG#32-#26
  4. For AWG #26~#28, Applicable wire: 1061,1571
  5. Q'ty / reel: 20,000 pcs

Part No.	Wire Range	Insulation O.D.	Material	Finishing
125100TC351	AWG#32~#26	0.5-1.1mm	Phosphor	Tin pre-plated
125100TC301	AWG#32~#26	0.5-1.1mm	Phosphor	Tin plated

UNLESS OTHERWISE SPECIFIED TOLERANCES  
 3 PLACE ±0.5 ±0.10  
 2 PLACE ±1.5 ±0.25  
 1 PLACE ±2.0 ±0.50  
 ANGLE DIM



REV.	REVISION	DIS	DATE	SCALE	REV.	PAGE	UNIT	mm	DWG NO:	PART.NO
8/1	A	1					THIRD ANGLE PROJECTION		C1251TC	125100TCxxx

10 9 8 7 6 5 4 3 2 1