

PART NO. 660400TPxxx
 DWG NO. C6604TP

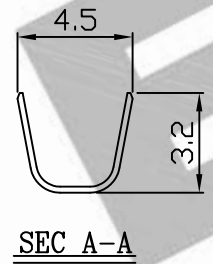

TA

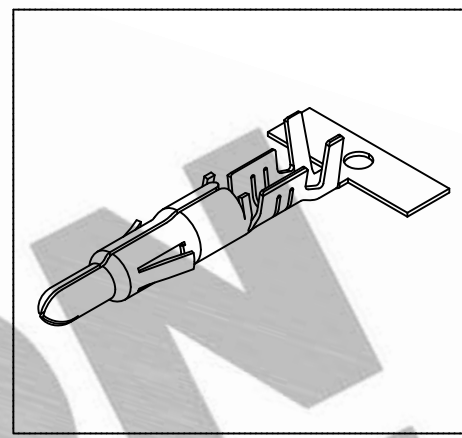
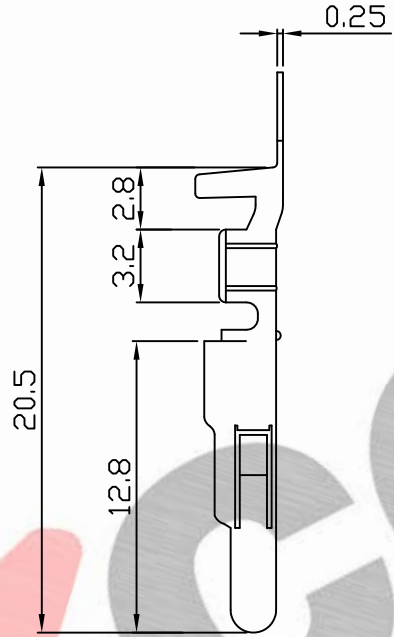
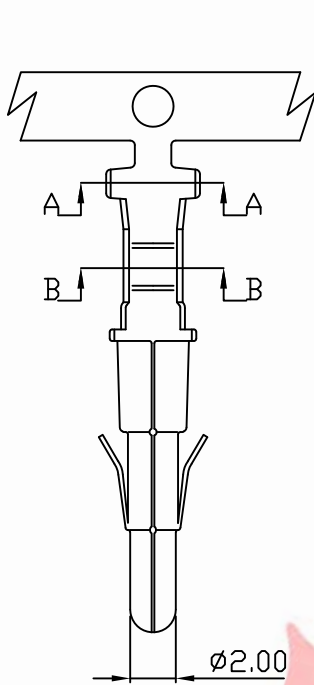
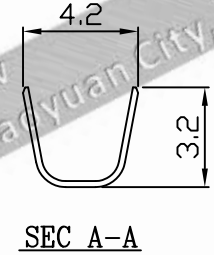
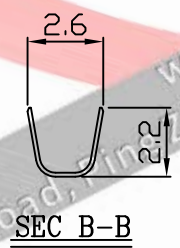

TP

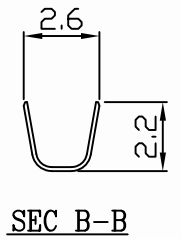

Part No.	Wire Range	Insulation O.D.	Material	Finishing
660400TA051	AWG#20~ #14	1.7-3.0mm	Brass	Tin pre-plated
660400TA351	AWG#20~ #14	1.7-3.0mm	Phosphor	
660400TP051	AWG#26~ #18	1.2-1.7mm	Brass	
660400TP351	AWG#26~ #18	1.2-1.7mm	Phosphor	

NOTE:

1. Terminal Material: Brass and phosphor bronze.
2. Plated: Ni 25u"min Tin-plated 50u"min.
3. Applicable wires: See table
4. Q'ty/reel: See table

UNLESS OTHERWISE SPECIFIED TOLERANCES
 3 PLACE ±0.5 ±0.10
 2 PLACE ±1.5 ±0.35
 1 PLACE ±2.0 ±0.50
 ANGLE DIM



REV.	REVISION		DIS	DATE	DWG NO:	PART.NO
4/1	A	1			C6604TP	660400TPxxx

THIRD ANGLE PROJECTION

