

PART NO. 420100TAxxx  
 DWG NO. C4201TA

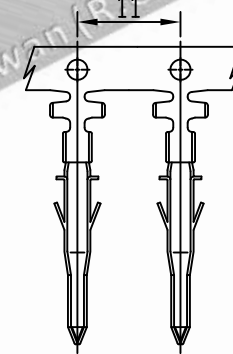
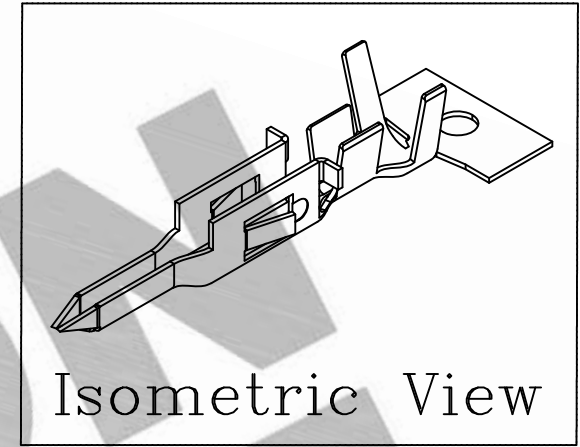
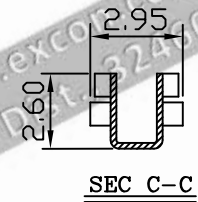
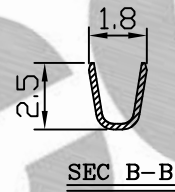
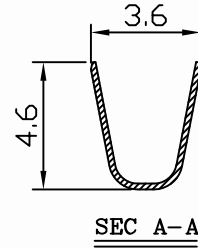
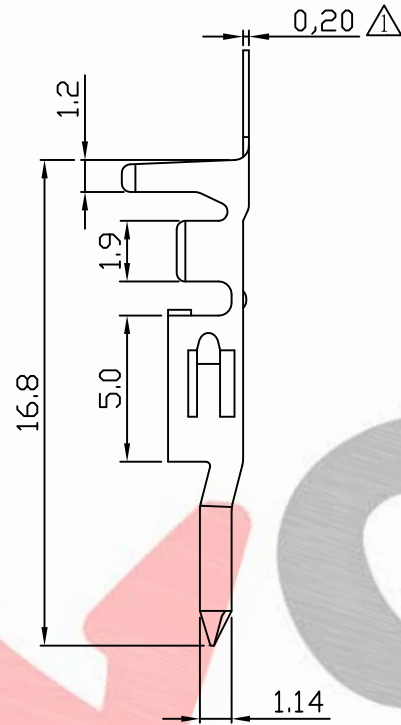
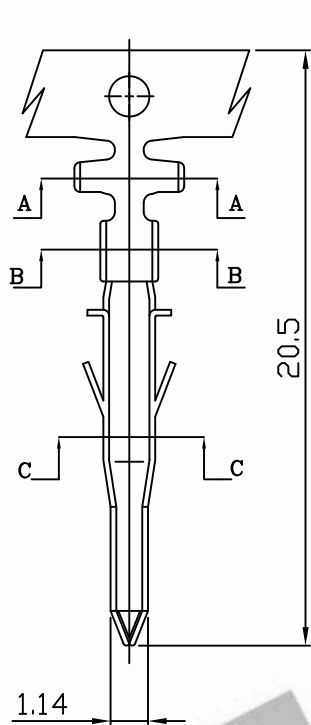

NOTE:

- Terminal Material: Brass bronze or Phosphor bronze
- Plated: Tin pre-plated 50u"min.
- Current rating: 5A AC/DC
- Voltage rating: 600V AC/DC
- Withstand voltage: 1500V AC/minute
- Insulation resistance: 1000MΩ min
- Insulation O.D.: 1.1~2.1mm
- Q'ty / reel: 4,000pcs

Dimensional & Ordering Information:

No.	Part No.	Wire Range	Material	Finishing
1	420100TA051	AWG#24~#18	Brass	Tin pre-plated
2	420100TA351	AWG#24~#18	Phosphor	Tin pre-plated

REV.	REVISIONI		DIS	DATE
C	DWG RELEASE		Christy	12/24 2015
B	NOTE: 修改 第 2 項 Tin-Plated → Tin pre-Plated 新增 第 3、4、5、6 項及數厚 T0.2		Christy	5/28 2015
SCALE	REV.	PAGE:	UNIT mm	
4/1	C	1/1	THIRD ANGLE PROJECTION	

UNLESS OTHERWISE SPECIFIED TOLERANCES  
 3 PLACE ±0.5 ±0.10  
 2 PLACE ±1.5 ±0.25  
 1 PLACE ±2.0 ±0.50  
 ANGLE DIM

**EXCON**  
 EXCON TECHNOLOGY COMPANY

SCALE	REV.	PAGE:	UNIT	mm	DWG NO:	PART.NO
4/1	C	1/1	THIRD ANGLE	PROJECTION	C4201TA	420100TAxxx