

■ Specifications

1. Current rating: 9A AC/DC
2. Voltage rating: 250V AC/DC
3. Withstand voltage: 1000V AC/minute
4. Insulation resistance: 1000M Ω min
5. Contact resistance: 10m Ω max
6. Temperature range: -40°C to +105°C
7. Applicable PC board thickness: 1.0~1.6mm(.039" to .063")
8. Applicable wires: AWG#24-#18
Insulation O.D.: 1.3-2.8mm
9. Circuits: 1~15 circuits available

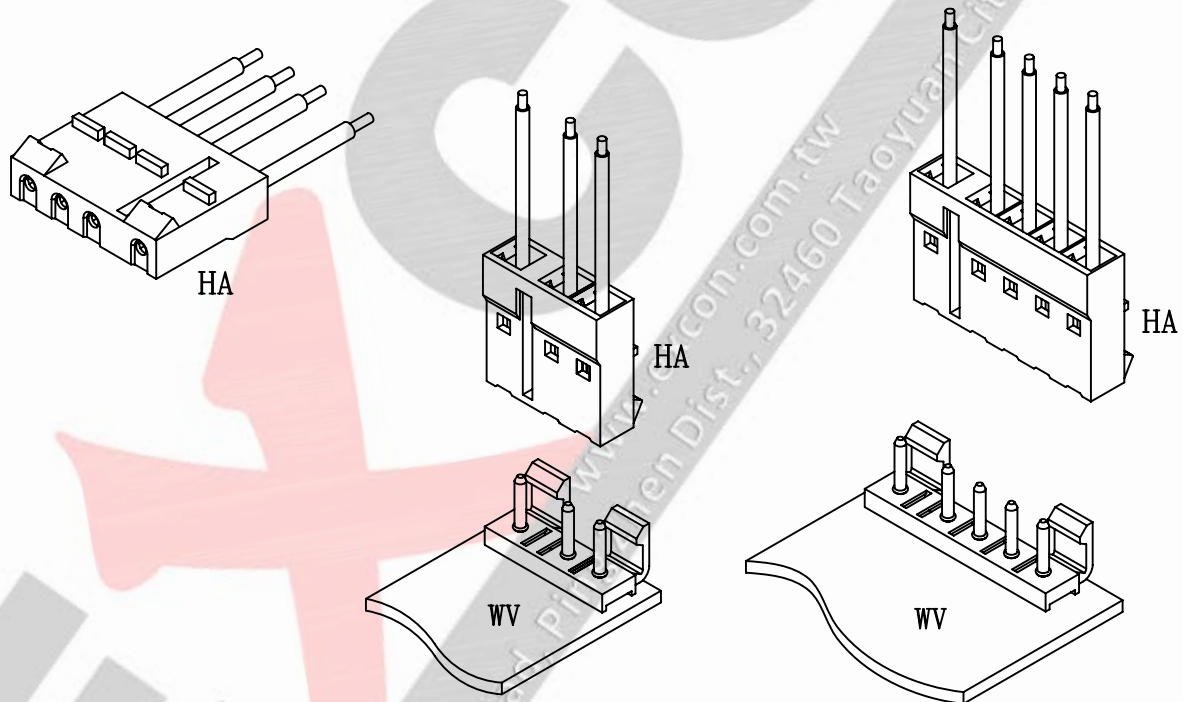

Part Code Information:

5090-WW XX YYY

① ② ③ ④

① Series Name

② Circuits Number

01~15

00 For Terminal

③ Product Type

HA=Housing

WV=Wafer (Vertical type)

WT=Wafer (Vertical type, round pin)

TC=Terminal

④ Material/Finishing/Color

351=Phosphor,Tin Pre-Plated

051=Brass bronze,Tin Pre-Plated

001=NY 66 94V0,Natural Color

Crimp Terminal

1. Part No.: 509000TC051,509000TC351
2. Part Name: 5090 Terminal
3. Material: Phosphor/Brass bronze
4. Finishing: Tin pre-plated

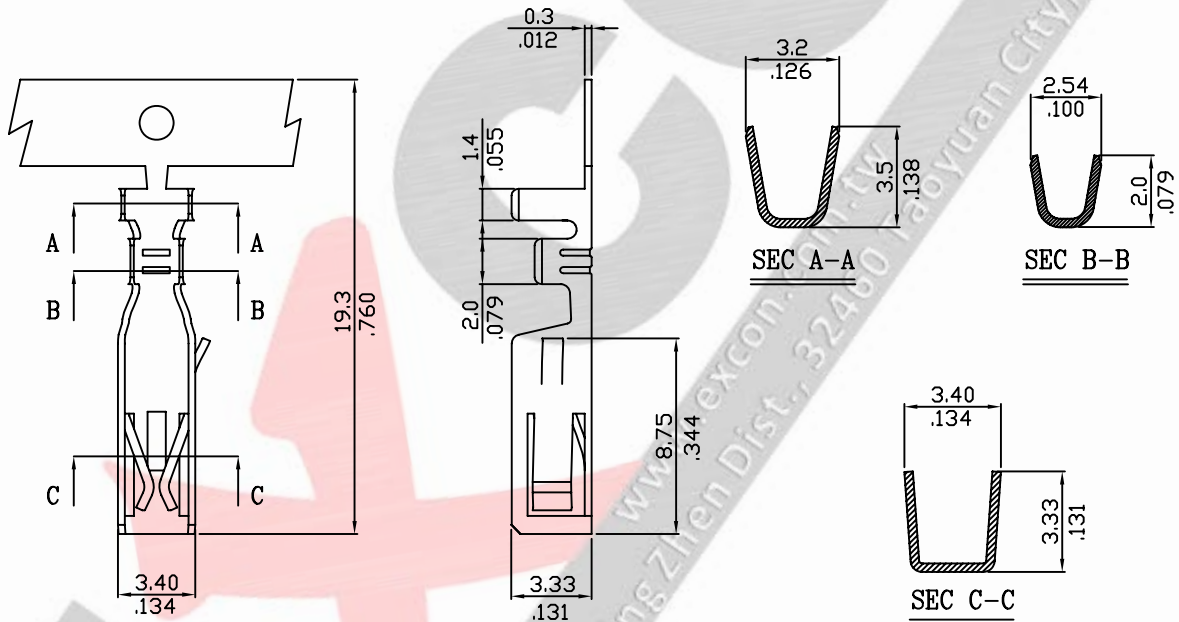
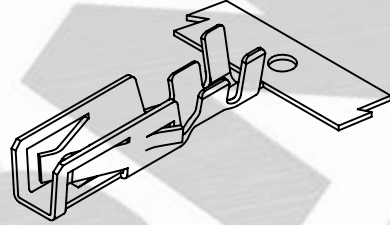

Ordering Information and Dimensions:

Part No.	Wire Range	Insulation O.D.	Material	Finishing	Q'ty/reel
509000TC051	AWG#26~#18	1.3-2.8mm	Brass	Tin pre-plated	6,000pcs
509000TC351	AWG#26~#18	1.3-2.8mm	Phosphor	Tin pre-plated	6,000pcs

Part Code Information:

5090-WW XX YY

① ② ③ ④

① Series Name

② Circuits Number

00 For Terminal

③ Product Type

TC=Terminal

④ Material/Finishing/Color

051=Brass bronze,Tin Pre-Plated
351=Phosphor,Tin Pre-Plated

Housing

1. Part No.: 5090xxHA001
2. Part Name: 5090 Housing
3. Material: Nylon 66 UL 94V0
4. Color: Natural

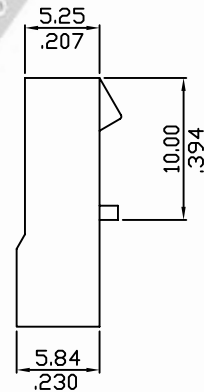
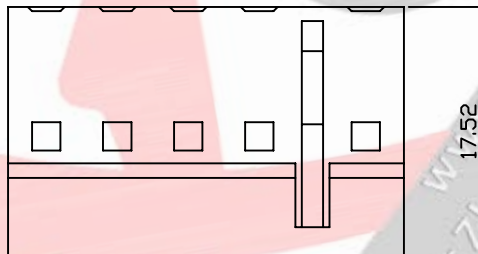
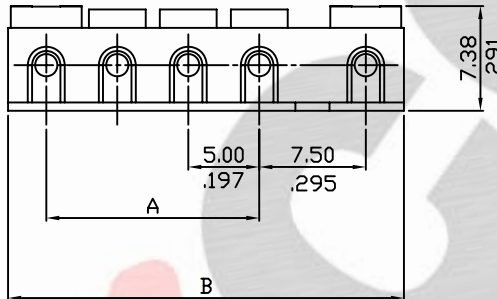
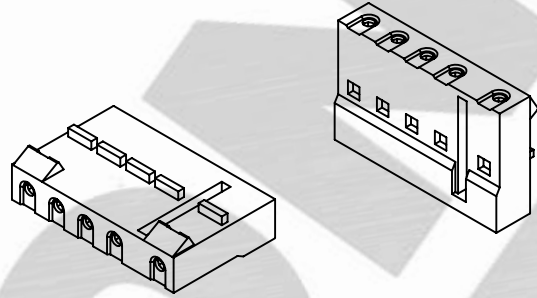

Ordering Information and Dimensions:

Part No.	Circuits	Dim A	Dim B	Part No.	Circuits	Dim A	Dim B
509001HA001	1	--	5.38(.212)	509009HA001	9	35.00(1.378)	47.88(1.885)
509002HA001	2	--	12.88(.507)	509010HA001	10	40.00(1.575)	52.88(2.082)
509003HA001	3	5.00(.197)	17.88(.704)	509011HA001	11	45.00(1.772)	57.88(2.279)
509004HA001	4	10.00(.394)	22.88(.901)	509012HA001	12	50.00(1.969)	62.88(2.476)
509005HA001	5	15.00(.591)	27.88(1.098)	509013HA001	13	55.00(2.165)	67.88(2.672)
509006HA001	6	20.00(.787)	32.88(1.294)	509014HA001	14	60.00(2.362)	72.88(2.869)
509007HA001	7	25.00(.984)	37.88(1.491)	509015HA001	15	65.00(2.559)	77.88(3.066)
509008HA001	8	30.00(1.181)	42.88(1.688)				

Part Code Information:

5090-WW XX YYY

① ② ③ ④

① Series Name

② Circuits Number
01~15

③ Product Type
HA=Housing

④ Material/Finishing/Color
001=NY 66 94V0,Natural Color

Wafer (Vertical type)

1. Part No.: 5090xxWV001
2. Part Name: 5090 Wafer
3. Material: Nylon 66 UL 94V0
Pin: Brass bronze, Tin plated
5. Color: Natural

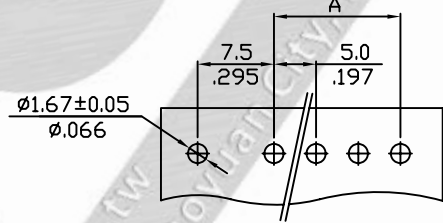
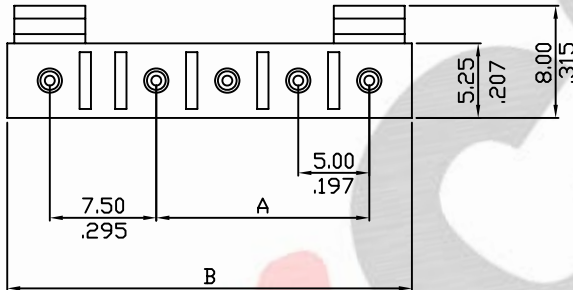
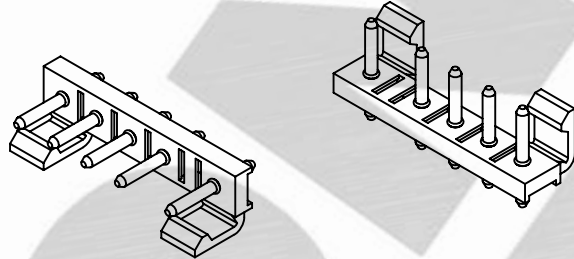

RECOMMENDED PCB LAYOUT

(PCB T=1.0~1.6mm)
(PCB T=.039~.063in)

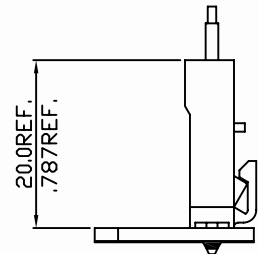
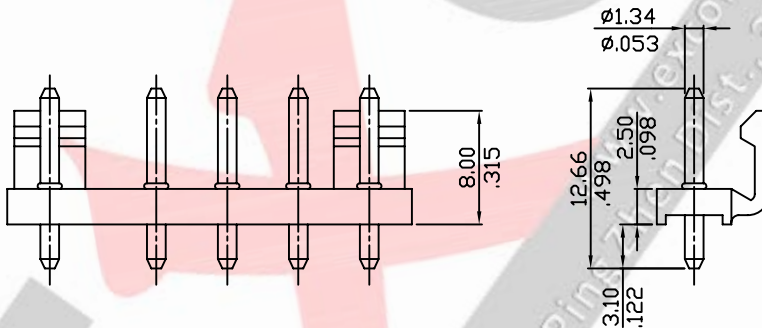

Mating Dimensions

Ordering Information and Dimensions:

Part No.	Circuits	Dim A	Dim B	Part No.	Circuits	Dim A	Dim B
509001WV001	1	--	6.00(.236)	509009WV001	9	35.00(1.378)	48.50(1.909)
509002WV001	2	--	13.50(.531)	509010WV001	10	40.00(1.575)	53.50(2.106)
509003WV001	3	5.00(.197)	18.50(.728)	509011WV001	11	45.00(1.772)	58.50(2.303)
509004WV001	4	10.00(.394)	23.50(.925)	509012WV001	12	50.00(1.969)	63.50(2.500)
509005WV001	5	15.00(.591)	28.50(1.122)	509013WV001	13	55.00(2.165)	68.50(2.697)
509006WV001	6	20.00(.787)	33.50(1.319)	509014WV001	14	60.00(2.362)	73.50(2.894)
509007WV001	7	25.00(.984)	38.50(1.516)	509015WV001	15	65.00(2.559)	78.50(3.091)
509008WV001	8	30.00(1.181)	43.50(1.713)				

Part Code Information:

5090-WW XX YY

① ② ③ ④

① Series Name

② Circuits Number

01~15

③ Product Type

WV=Wafer (Vertical type)

④ Material/Finishing/Color

001=NY 66 94V0,Natural Color

Wafer (Vertical type)

1. Part No.: 5090xxWT001
2. Part Name: 5090 Wafer
3. Material: Nylon 66 UL 94V0
Pin: Brass bronze, Tin plated
5. Color: Natural

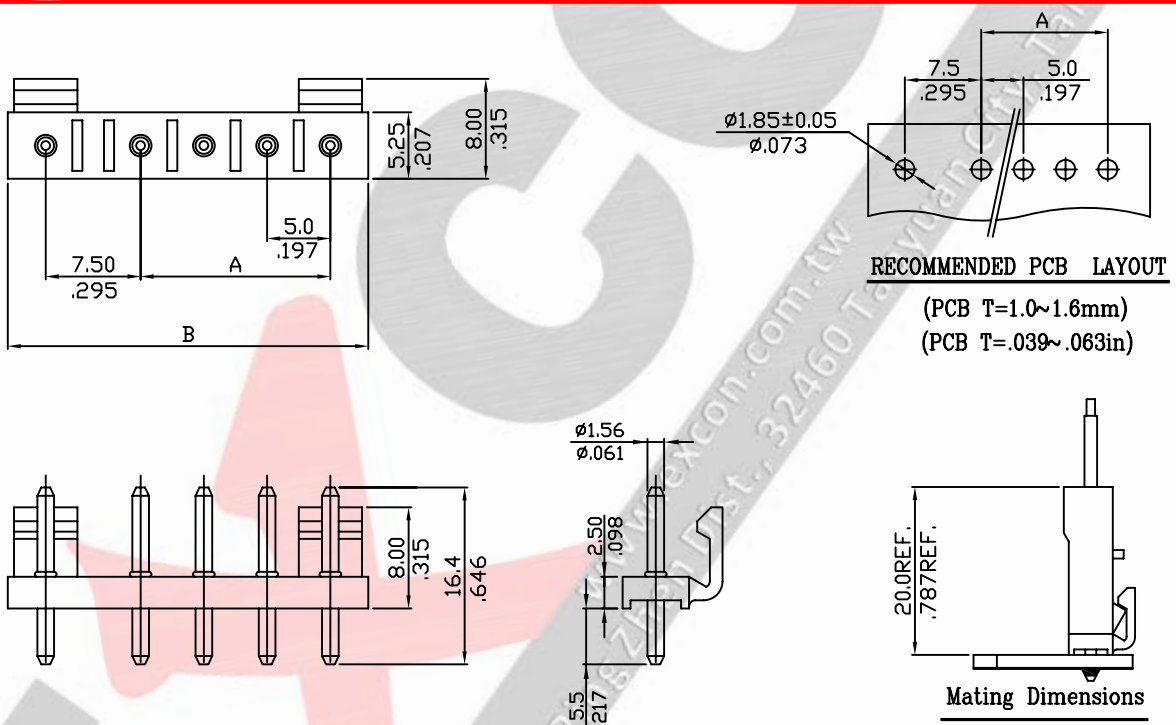
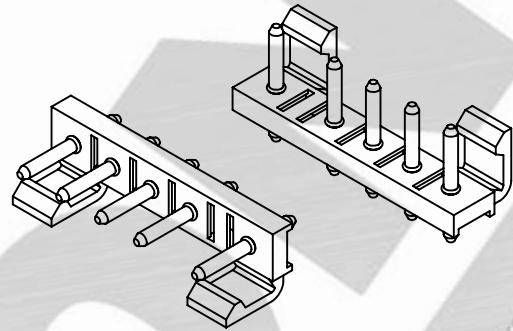

Ordering Information and Dimensions:

Part No.	Circuits	Dim A	Dim B	Part No.	Circuits	Dim A	Dim B
509001WT001	1	--	6.00(.236)	509009WT001	9	35.00(1.378)	48.50(1.909)
509002WT001	2	--	13.50(.531)	509010WT001	10	40.00(1.575)	53.50(2.106)
509003WT001	3	5.00(.197)	18.50(.728)				
509004WT001	4	10.00(.394)	23.50(.925)				
509005WT001	5	15.00(.591)	28.50(1.122)				
509006WT001	6	20.00(.787)	33.50(1.319)				
509007WT001	7	25.00(.984)	38.50(1.516)				
509008WT001	8	30.00(1.181)	43.50(1.713)				

Part Code Information:

5090-WW XX YY

① ② ③ ④

① Series Name

② Circuits Number

01~10

③ Product Type

WT=Wafer (Vertical type, round pin)

④ Material/Finishing/Color

001=NY 66 94V0,Natural Color