

### ■ Specifications

1. Current rating: 3A AC/DC
2. Voltage rating: 250V AC/DC
3. Withstand voltage: 1500V AC/minute
4. Insulation resistance: 500M  $\Omega$  min
5. Contact resistance: 10m  $\Omega$  max
6. Temperature range: -25°C to +105°C
7. Applicable panel thickness: 0.5~2.0mm (.020"~.079")
8. Applicable wires: AWG#28-#22  
Insulation O.D.: 1.2-1.8mm
9. Circuits: 2~12 circuits available

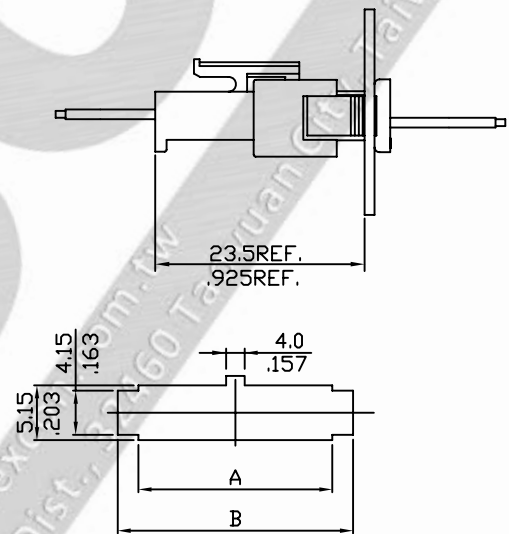
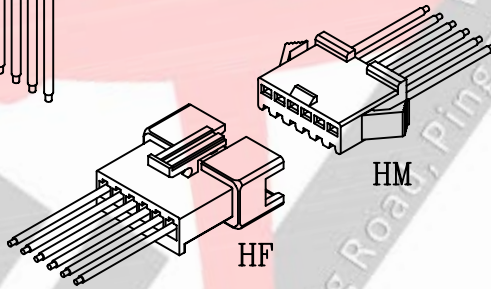
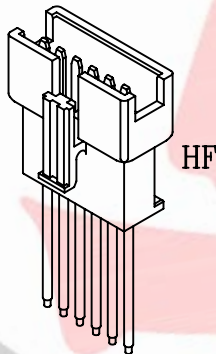
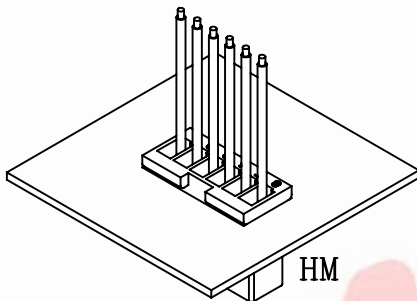

Panel Hole Layout

Layout Dimensions:

Circuits	Dim A	Dim B	Circuits	Dim A	Dim B
2	5.7(.224)	9.6(.378)	8	20.7(.815)	24.6(.969)
3	8.2(.323)	12.1(.476)	9	23.2(.913)	27.1(1.067)
4	10.7(.421)	14.6(.575)	10	25.7(1.012)	29.6(1.165)
5	13.2(.520)	17.1(.673)	11	28.2(1.110)	32.1(1.264)
6	15.7(.618)	19.6(.772)	12	30.7(1.209)	34.6(1.362)
7	18.2(.717)	22.1(.870)			

### Part Code Information:

2507,2508-WW XX YYY

① ② ③ ④

① Series Name

② Circuits Number  
02~12

00 For Terminal

③ Product Type

HM=Housing Male

HF=Housing Female

TA=Terminal,male type

TB=Terminal,female type

④ Material/Finishing/Color

051=Brass,Tin Pre-Plated

351=Phosphor,Tin Pre-Plated

003=NY 66 94V0,Black Color

### Crimp Terminal

1. Part No.: 250800TA051 ,250800TA351
2. Part Name: 2508 Terminal
3. Material: Brass Phosphor
4. Finishing: Tin pre-plated

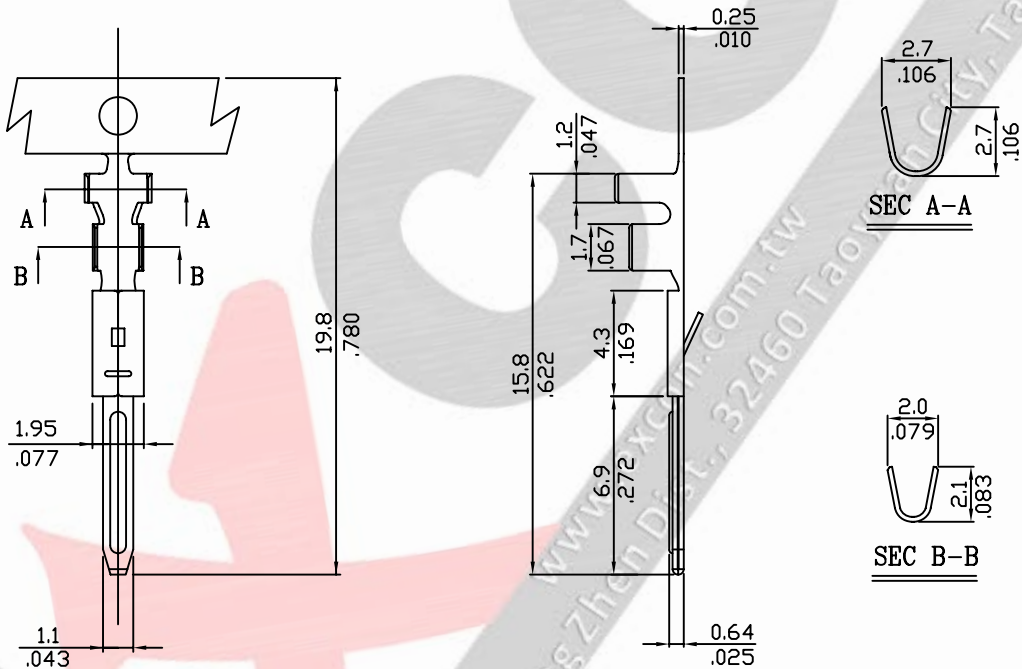
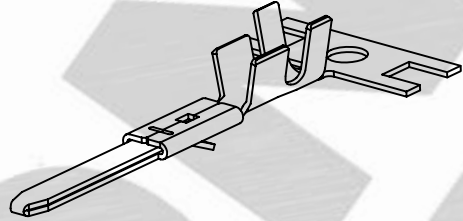

### Ordering Information and Dimensions:

Part No.	Wire Range	Insulation O.D.	Material	Finishing	Q'ty/reel
250800TA051	AWG#28~#22	1.2-1.8mm	Brass	Tin pre-plated	7,000pcs
250800TA351	AWG#28~#22	1.2-1.8mm	Phosphor	Tin pre-plated	7,000pcs

### Part Code Information:

2508-WW XX YYY

① ② ③ ④

① Series Name

② Circuits Number  
00 For Terminal

③ Product Type

TA=Terminal,male type

④ Material/Finishing/Color

051=Brass,Tin Pre-Plated

351=Phosphor,Tin Pre-Plated

### Housing

1. Part No.: 2508xxHF003
2. Part Name: 2508 Housing Female
3. Material: Nylon 66 UL 94V0
4. Color: Black

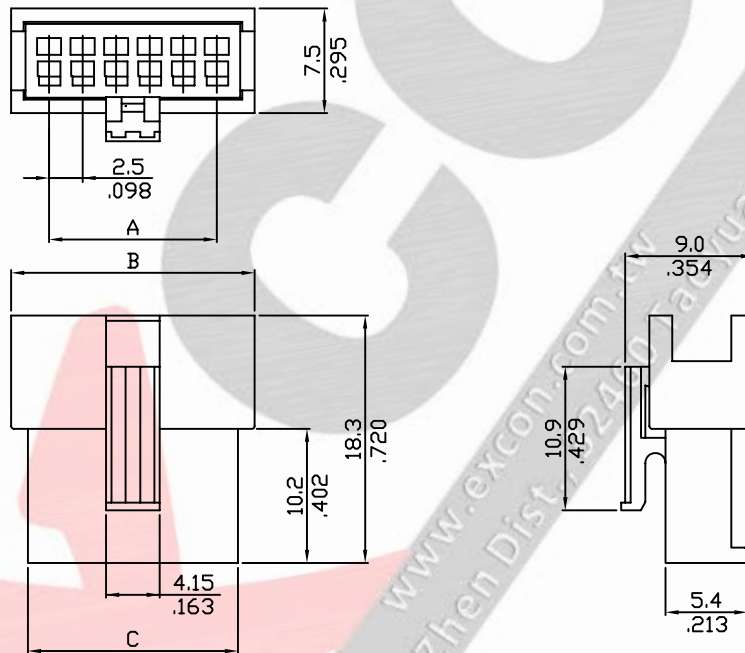
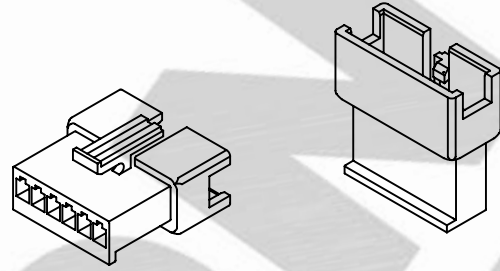

### Ordering Information and Dimensions:

Part No.	Circuits	Dim A	Dim B	Dim C	Part No.	Circuits	Dim A	Dim B	Dim C
250802HF003	2	2.5(.098)	8.0(.315)	5.6(.220)	250808HF003	8	17.5(.689)	23.0(.906)	20.6(.811)
250803HF003	3	5.0(.197)	10.5(.413)	8.1(.319)	250809HF003	9	20.0(.787)	25.5(1.004)	23.1(.909)
250804HF003	4	7.5(.295)	13.0(.512)	10.6(.417)	250810HF003	10	22.5(.886)	28.0(1.102)	25.6(1.008)
250805HF003	5	10.0(.394)	15.5(.610)	13.1(.518)	250811HF003	11	25.0(.984)	30.5(1.201)	28.1(1.106)
250806HF003	6	12.5(.492)	18.0(.709)	15.6(.614)	250812HF003	12	27.5(1.083)	33.0(1.299)	30.8(1.205)
250807HF003	7	15.0(.591)	20.5(.807)	18.1(.713)					

### Part Code Information:

2508-WW XX YY

① ② ③ ④

① Series Name

② Circuits Number  
02~12

③ Product Type

HF=Housing Female

④ Material/Finishing/Color

003=NY 66 94V0,Black Color